

PLAN II SPRING THESIS

Symposium



APRIL 14, 2013

MAP OF SESSION ROOM LOCATIONS



CONTENTS

2	The Day at a Glance
4	Alphabetical Index of Students with Session Number
5	Session One 10:15 a.m. - 11:45 a.m.
8	Session Two 12:00 p.m - 1:30 p.m.
11	Session Three 1:45 p.m - 3:15 p.m.
14	Session Four 3:30 p.m. - 5:00 p.m.
17	Make-up Session Presenters
18	Session Moderators, Plan II Staff
19	Map of Session room locations

Participant and Moderator Check-In

Please pick up a name tag and program at the Plan II table
outside CLA 0.130, 10 am - 3:30 pm

Refreshments available next to check-in table, 10:00 a.m. - 3:00 p.m.

Compliments of Plan II Honors Program

The Day at a Glance

SESSION I

10:15 AM - 11:45 AM

1.1 Race, Gender, and Social Change CLA 0.130

Moderator: Dana L. Cloud

1.2 Psychology CLA 0.128

Moderator: Ann Repp

1.3 Representing History CLA 0.126

Moderator: Judith Coffin

1.4 Literature and Philosophy CLA 0.112

Moderator: Brian Doherty

**1.5 Creative Theses I:
Fiction and Poetry** CLA 0.102

Moderator: Michael Adams

1.6 Aesthetics and Social Experience CLA 1.106

Moderator: Cynthia Francica

SESSION 2

12:00 PM - 1:30 PM

**2.1 Conservation and the
Environment** CLA 0.130

Moderator: Robert Jensen

2.2 Biology/Chemistry/Engineering CLA 0.128

Moderator: Stanley Reiser

2.3 Women's Health CLA 0.126

Moderator: Kristine Hopkins

2.4 American Politics CLA 0.112

Moderator: Daron Shaw

2.5 Film and Contemporary Culture CLA 0.102

Moderator: Coleman Hutchison

The Day at a Glance

SESSION 3

1:45 PM - 3:15 PM

3.1 Language: Acquisition and Power CLA 0.130
Moderator: Michael Harney

3.2 Science and Technology CLA 0.128
Moderator: Austin Gleeson

3.3 Ethical Issues in Healthcare CLA 0.126
Moderator: William Winslade

3.4 Business/Economics CLA 0.112
Moderator: Beverly Hadaway

3.5 Music as Cultural Discourse CLA 0.102
Moderator: Julie Casey

3.6 Human Rights and the Law CLA 1.106
Moderator: Mary Rose

SESSION 4

3:30 PM - 5:00 PM

4.1 The Politics of Marriage and the Family CLA 0.130
Moderator: Penny Green

4.2 Technology and Society CLA 0.128
Moderator: Paul Sullivan

4.3 America in/and History CLA 0.126
Moderator: Julie Casey

4.4 Global Studies in Culture and Politics CLA 0.112
Moderator: Cynthia Francica

4.5 Creative Theses II: Music and Drama CLA 0.102
Moderator: James Loehlin

4.6 Global Health and Human Rights CLA 1.106
Moderator: Stephen Sonnenberg

Alphabetical Student Index with Session Number

Abell, Nathan, 2.2
Acosta, Lauren, 1.1
Alexander, Travis, 1.4
Alexander, Marc A., 4.4
Andrews, Taylor, 3.6
Armstrong, Alice, 1.6
Attia, Monica, 4.4
Barrett, Ben, 2.4
Bates, Molly, 4.6
Beaumont, Russell, 1.6
Berney, Jesse, 3.2
Binder, Jeannie, 3.5
Boven, Zachary, 1.1
Brooke, Jillian, 4.2
Cacciatore, Christopher, 2.2
Chen, Jia, 1.1
Chuang, Teresa, 2.3
Chung, Sonya, 4.6
Clarke, Alexander, 4.2
Clegg, Kevin, 2.5
Comito, Shelby C., 1.5
Consolino, Dina, 3.4
Craik, Natalie, 2.2
Davis, Alyssa, 4.1
Demkowicz, Monika, 1.2
Dzienkowski, Alexandra, 2.5
Edrington, Victoria, 4.1
Evans, Kimberly, 3.2
Fife, Katie, 1.1
Fine, Callie, 4.1
Fraden, Clara, 2.5
Franklin, Lauren, 3.1
Fraser, Gracie, 4.3
Gill, Richie, 1.6
Grbavac, Andrea, 3.1
Gu, Jandy, 4.2
Guidorzi, Brianna, 2.3
Harris, Catherine, 1.3
Hau, Helen, 1.6
Hergenroeder, Georgene, 4.6
Herriage-Wilson, Price, 4.1
Howorth, Thaisa, 4.5
Hsu, Ashley, 3.6
Humann, WJ, 3.3
Kling, Katherine, 2.1
Kloc, Katherine, 1.4
Koenig, Jack, 3.2
Kreager, Kate, 1.3
Kutner, Jenny, 1.4
Kwon, Alex, 4.2
Lai, Eric, 3.6
LaMoure, Marissa, 2.1
Law, Jade, 3.3
Liebl, Samuel, 2.1
Liu, David G. , 1.4
Liu, Xuemiao (Mia), 2.4
Lord, Annie, 2.1
Mallett, David, 1.2
Maxon, Lindsey, 1.5
McLeod IV, Angus, 4.3
Miller, Kalyn, 2.5
Montecillo, Io Paulo E., 1.3
Naeve, Patrick, 4.5
Najmi, Fatema, 1.6
Namaky, Nauder, 1.2
Nambiar, Anjali, 2.3
Needel, Aneesa Gupta, 4.5
Nguyen, Thuyen H. , 2.3
Nguyen, Crystal, 3.4
Ordoñez, José, 4.3
Pope, Ana, 1.4
Prakash, Priya, 4.4
Proctor, Emmie, 3.5
Rabie, Shereen, 1.5
Rafferty, Kevin, 2.4
Raja, Isbah, 2.4
Rhea, Sam, 4.3
Rogers, Austin, 3.6
Roldan, Johann, 4.4
Rosner, Marla, 3.1
Rowland, Jonathan W., 3.3
Saifuddin, Mustafa, 2.2
San Luis, Natalie, 3.5
Schlesinger, Madeline, 1.3
Schneider, Anna, 2.1
Severen, Kaytiann, 4.1
Shah, Rishi, 4.3
Shih, Stephanie, 3.4
Singh, Saloni, 2.2
Siva, Lisa, 1.5
Thompson, Kelsey, 1.1
Van Matre, Jr., E. James, 3.1
Varadhan, Balaji, 3.4
Verma, Swati, 4.4
Watt, Hannah, 3.5
Wardlaw, Harold Charles, 3.2
Webb, Andy, 4.5
Wen, Nicole, 1.2
White, Audrey, 2.3
Widmann, Duncan, 2.4
Wilbanks, Sarah E., 4.6
Williams, Haziell A., 3.3
Wolfrom, Megan, 4.6
Wu, Caiqian, 1.2
Zagorin, Katharyn, 1.3
Zhang, Linhao, 4.2
Zhu, James, 3.4

Session One 10:15 a.m. - 11:45 p.m.

1.1 Race, Gender & Social Change

CLA 0.130

MODERATOR: DANA L. CLOUD, COMMUNICATION STUDIES

- Lauren Acosta So sexy, So young: The Effects of Sexualized Media Exposure on Preteen Girls
Supervisor: Rebecca Bigler, Psychology
- Zachary Boven Rowing as a Sport for Development Opportunity for Urban, Low-Income Youth
Supervisor: Christine Green, Kinesiology and Health Education
- Jia Chen School Quality and its Effect on Asian American Student Achievement
Supervisor: Sandra Black, Economics
- Katie Fife How to Create Change for Minority Groups Today: Learning from the Radical
Tactics Employed in the 1960s Black Civil Rights Movement
Supervisor: Dana L. Cloud, Communication Studies
- Kelsey Thompson Ayn Rand vs. Ethics of Care: Capitalist Economics and Women on Welfare
Supervisor: Dana L. Cloud, Communication Studies

1.2 Psychology

CLA 0.128

MODERATOR: ANN REPP, PSYCHOLOGY

- Monika Demkowicz Parents' Personality and Infant's Temperament as Contributors to the
Parent-Infant Relationship: A Case Study
Supervisor: Ann Repp, Psychology
- David Mallett Principles of Addiction and Recovery: Science of the 12 Steps
Supervisor: Lori Holleran-Steiker, Social Work
- Nauder Namaky Cognitive Enhancement: Methods, Applications, and Ethical Concerns
Supervisor: Michael Telch, Psychology
- Nicole Wen Spot the Difference: Examining Detection of Behavioral Deviation in
Conventional Learning
Supervisor: Cristine Legare, Psychology
- Caiqian Wu The Effects of Friendship on Physical Health
Supervisor: Kirsten Bradbury, Psychology

1.3 Representing History

CLA 0.126

MODERATOR: JUDITH COFFIN, HISTORY

- Catherine Harris Daniel Defoe and the Churches of England and Scotland: National Prejudice in the Union of 1707
Supervisor: Brian Levack, History
- Kate Kreager The Representation of the Holocaust in Contemporary Dance and Performance
Supervisor: Robert Abzug, Jewish Studies and History
- Io Paulo E. Montecillo The Walsingham Way: The History, People, and Patrimony of Anglo-Catholics and Our Lady of Walsingham Catholic Church from Pre-Reformation to the Anglican Ordinariates
Supervisor: Anne M. Martinez, History
- Madeline Schlesinger The Hadamar Murder Factory Trial: A Case Study of Early Post World War II Justice
Supervisor: Robert Abzug, Jewish Studies and History
- Katharyn Zagorin Second-hand Loot: The Story of Hitler's Plundered Works of Art and Their Controversial Presence in American Museums
Supervisor: Judith Coffin, History

1.4 Literature and Philosophy

CLA 0.112

MODERATOR: BRIAN DOHERTY, ENGLISH

- Travis Alexander Under the Influence: Class Fictions, Neonaturalism, and the Grotesque in Charles Bukowski's *Ham on Rye*
Supervisor: Brian Bremen, English
- Katherine Kloc To Know the Outline, Not the Detail: Human Connection in Virginia Woolf's *To the Lighthouse*
Supervisor: Mia Carter, English
- Jenny Kutner This Is What We Do: Postfeminism and the Third Wave in Contemporary Women's Literary Fiction
Supervisor: Heather Houser, English
- David G Liu Hidden Hiddenness: The Challenge and Opportunity of Divine Hiddenness for Christian Theism
Supervisor: Robert Koons, Philosophy
- Ana Pope A Problem of Incompatibility: The Surprising Dynamics of Love and Intimacy in Alice Munro's Short Fiction
Supervisor: Brian Doherty, English

1.5 Creative Theses I: Fiction and Poetry

CLA 0.102

MODERATOR: MICHAEL ADAMS, ENGLISH

Shelby C. Comito The Intensity of Light on Water: A Collection of Poems
Supervisor: David Wevill, English

Lindsey Maxon Verge and Lockey: A Short Fiction Collection
Supervisor: Larry Carver, English

Shereen Rabie Automaton 5
Supervisor: Elizabeth Richmond-Garza, English

Lisa Siva Ghost Stories
Supervisor: Michael Adams, English

1.6 Aesthetics and Social Experience

CLA 1.106

MODERATOR: CYNTHIA FRANCICA, PLAN II HONORS PROGRAM

Alice Armstrong Science Fiction and the City of the Future: Urban Planning through
Cognitive Estrangement
Supervisor: Stephen Ross, Architecture

Russell Beaumont The Social and Architectural Impact of Disaster Relief Housing
Supervisor: Lawrence Speck, Architecture

Richie Gill A Study on Student Housing and Academic Performance
Supervisor: Lawrence Speck, Architecture

Helen Hau The Aesthetic Experience Through the Eyes of Neuroscience
Supervisor: Linda D. Henderson, Art and Art History

Fatema Najmi The Iconography of the Heart: From Ancient Egypt through the Medieval Times
Supervisor: Todd Curtis, Classics

Session Two 12:00 - 1:30 p.m.

2.1 Conservation and the Environment

CLA 0.130

MODERATOR: ROBERT JENSEN, JOURNALISM

- Katherine Kling An Analysis of the Current State of Primate Conservation Education:
Can We Help Primates Make the Grade?
Supervisor: Mariah Hopkins, Anthropology
- Marissa LaMoure Drought, Plant Plasticity, and Agriculture
Supervisor: Christine Hawkes, Integrative Biology
- Samuel Liebl Radical Environmentalism in Texas: Common Fears, Different Actions
Supervisor: Robert Jensen, Journalism
- Annie Lord Riparian Redemption: The Role of German River Management in the Formation
of an Environmental European Community
Supervisor: David Eaton, Lyndon B. Johnson School of Public Affairs
- Anna Schneider Beyond Local: Sustainable Agriculture that Can Be Practiced on a Global Scale
Supervisor: Robyn Metcalfe, History

2.2 Biology/Chemistry/Engineering

CLA 0.128

MODERATOR: STANLEY REISER, UT SCHOOL OF PUBLIC HEALTH

- Nathan Abell Subcellular Localization and Transcriptome-Wide RNA Binding Profiles of
Argonaute Proteins in Cultured Human Cell Lines
Supervisor: Vishwanath Iyer, Cell and Molecular Biology
- Christopher Cacciatore Inhibition of Hepatitis C NS3/4A and GRB2 Protein Systems
Supervisor: Stephen F. Martin, Chemistry and Biochemistry
- Natalie Craik Persistence of Cryotherapy Induced Ischemia for Hours after Cooling Ends
Supervisor: Kenneth Diller, Biomedical Engineering
- Mustafa Saifuddin Colony Variation in Yellow-faced Bumble Bee Foraging Preferences
Supervisor: Shalene Jha, Section of Integrative Biology
- Saloni Singh Respiratory Viral Infection in Probable Cases of Pertussis in Texas from
September 2011-February 2012
Supervisor: Leanne Field, Biological Sciences

2.3 Women's Health

CLA 0.126

MODERATOR: KRISTINE HOPKINS, SOCIOLOGY

- Teresa Chueng Adherence to Anti-retroviral Therapy Among HIV-positive Mothers in Indonesia
Supervisor: Kristine Hopkins, Sociology
- Brianna Guidorzi When Expectation Does Not Meet Reality: Discordant Childbirth Narratives
among Austin-Area Women
Supervisor: Kristine Hopkins, Sociology
- Anjali Nambiar Academic Achievement and Women's Health: An Exploration of Connections
Between Educational Attainment and Risk Factors for Cervical Cancer
Supervisor: Alfred McAlister, UT School of Public Health
- Thuyen H. Nguyen The Role of Sex-Gender Differences in Weight Management Programs
Supervisor: Jaimie Davis, Human Ecology
- Audrey White Crisis Pregnancy Centers in Texas: A Journalistic Look at a Controversial
State Program
Supervisor: Tracy Dabby, Journalism

2.4 American Politics

CLA 0.112

MODERATOR: DARON SHAW, GOVERNMENT

- Ben Barrett The Polarizing Consequences of a Changing Electorate: The United States'
Journey toward a Functioning Democracy
Supervisor: Sean Theriault, Government
- Xuemiao (Mia) Liu Battle of the Frames: How Parties Condition Framing Effects
Supervisor: Daron Shaw, Government
- Kevin Rafferty The Tea Party and Fiscal Policy: Strategy and Consequence
Supervisor: Sean Theriault, Government
- Isbah Raja Lying in the Public Domain: A Study on the Methodology and Data of Politifact
Supervisor: David Prindle, Government
- Duncan Widmann The Real Impact of Third Party and Independent Presidential Candidates in
Modern American Elections
Supervisor: Daron Shaw, Government

2.5 Film and Contemporary Culture

CLA 0.102

MODERATOR: COLEMAN HUTCHISON, ENGLISH

- Kevin Clegg The 21st Century Energy Transition as Captured in Film
Supervisor: Michael Webber, Mechanical Engineering
- Alexandra Dzienkowski “Shaken, not Stirred”: Daniel Craig's James Bond in the Post-9/11 and 7/7 World
Supervisor: Mia Carter, English
- Clara Fraden West of No Return: West Texas as Symbolic Landscape in Film
Supervisor: Coleman Hutchison, English
- Kalyn Miller Reel History: Contemporary Representations of the Holocaust in
American Cinema
Supervisor: Pascale Bos, Germanic Studies

Session Three 1:45 - 3:15 p.m.

3.1 Language: Acquisition and Power

CLA 0.130

MODERATOR: MICHAEL HARNEY, SPANISH AND PORTUGUESE

- Lauren Franklin The Critical Period Hypothesis and its Implications on Accent Acquisition of Adult Hebrew Learners
Supervisor: Adi Raz, Middle Eastern Studies
- Andrea Grbavac France, Yugoslavia, & Spain: The Implications of Competing Cultural and Linguistic Interests on Centuries of Attempts at Nation-Building
Supervisor: Michael Harney, Spanish and Portuguese
- Marla Rosner Pragmatic Referring Expressions in Children
Supervisor: Colin Bannard, Linguistics
- E. James Van Matre, Jr. Classroom Dynamics: A Qualitative Look at High School Spanish Language Acquisition
Supervisor: Jorge Gomez-Bocanegra, Spanish and Portuguese

3.2 Science and Technology

CLA 0.128

MODERATOR: AUSTIN GLEESON, PHYSICS

- Jesse Berney Understanding Formation Mechanisms and Conditions for Lobate Debris Aprons in the Northern Mid-Latitudes of Mars
Supervisor: Jack Holt, UT Institute for Geophysics
- Kimberly Evans Ebola and Mathematical Modeling: Should Models Be Modified to Include Culture and Politics?
Supervisor: Maria Croyle, College of Pharmacy
- Jack Koenig Early Stage Power Modeling
Supervisor: Derek Chiou, Electrical & Computer Engineering
- Harold Charles Wardlaw Controlling Long Distance Lasers
Supervisor: Aaron Bernstein, Physics

3.3 Ethical Issues in Healthcare

CLA 0.126

MODERATOR: WILLIAM WINSLADE, PLAN II HONORS PROGRAM

- WJ Humann Considerations on the Deliberate Use of Disease in Ancient, Medieval, and Early Modern Warfare
Supervisor: William Winslade, Plan II Honors Program
- Jade Law Two Victims of Alzheimer's: Examining the Burdens and Motives of Alzheimer's Caregivers
Supervisor: Ronald Carson, Plan II Honors Program
- Jonathan W. Rowland Vulnerable Populations: Cosmetic Surgery in Korea
Supervisor: William Winslade, Plan II Honors Program
- Haziel A. Williams Approaching Cultural Diversity in End-of-Life Care: The Ethical Implications and Practical Challenges of Achieving a Culturally Competent System of End-of-life Care in America
Supervisor: Ronald Carson, Plan II Honors Program

3.4 Business/Economics

CLA 0.112

MODERATOR: BEVERLY HADAWAY, FINANCE

- Dina Consolino Sharia Sanctions on Microfinance
Supervisor: Beverly Hadaway, Finance
- Crystal Nguyen Perceptions of Success: Racial Gaps in Leadership Emergence
Supervisor: Ethan Burris, Management
- Stephanie Shih The Key Drivers of Successful Marketing Strategy for Social Enterprise
Supervisor: David C. Warner, Lyndon B. Johnson School of Public Affairs
- Balaji Varadhan Foresight in Hindsight: Economists and the Financial Crisis
Supervisor: James K. Galbraith, Lyndon B. Johnson School of Public Affairs
- James Zhu Income-Contingent Student Loans in the United States
Supervisor: Beverly Hadaway, Finance

3.5 Music as Cultural Discourse

CLA 0.102

MODERATOR: JULIE CASEY, HUMANITIES

- Jeannie Binder Porgy and Bess: Signifyin(g), the Modernist Discourses, and Conceptions of Authenticity
Supervisor: Charles Carson, Butler School of Music
- Emmie Proctor 'All The World's A Stage:' Adaptations of Shakespeare's Classics into Uniquely American Broadway Musicals
Supervisor: Andrew Carlson, Theatre and Dance
- Natalie San Luis Livin' No Limits: Representations of Wealth and Methods of Transgression in Hip Hop
Supervisor: Karl Hagstrom-Miller, History
- Hannah Waitt The History, Development, and Future of K-Pop and the Korean Music Industry
Supervisor: Michael Anderson, Government

3.6 Human Rights and the Law

CLA 1.106

MODERATOR: MARY ROSE, SOCIOLOGY

- Taylor Andrews International Influence on the American Capital Punishment System
Supervisor: Mary Rose, Sociology
- Ashley Hsu Assessing the Arguments of Capital Punishment: the 1960's and the Present
Supervisor: Sheldon Ekland-Olson, Sociology
- Eric Lai Judicial and Legislative Responses to Statistical Evidence in Capital Cases
Supervisor: James C. Harrington, Law School
- Austin Rogers Evolution of Enfranchisement: Changing Standards of Judicial Review as a Catalyst for the Extension of Constitutional Rights to LGBT Americans
Supervisor: Christopher Meakin, Business, Government and Society

Session Four 3:30 - 5:00 p.m.

4.1 The Politics of Marriage and the Family

CLA 0.130

MODERATOR: PENNY GREEN, SOCIOLOGY

- Alyssa Davis U.S. Family Leave Policy: A Corporate Perspective
Supervisor: Penny Green, Sociology
- Victoria Edrington Psychology of Varying Levels of Openness in Adoption
Supervisor: Susan Ayers-Lopez, Social Work
- Callie Fine Parental Involvement and Socioeconomic Achievement Disparities in Education: Understanding Constraints and Optimizing Involvement to Narrow the Gap
Supervisor: Amy Bryan, Human Development and Family Sciences
- Price Herriage-Wilson Forced Marriage Legislation and Policy in the U.S. and the U.K.
Supervisor: Barbara Anderson, School of Social Work
- Kaytiann Severen Victorious or Vulnerable: Is Integrative Thinking Helpful to Newlyweds Experiencing Stress Spillover?
Supervisor: Lisa Neff, Human Development and Family Sciences

4.2 Technology and Society

CLA 0.128

MODERATOR: PAUL SULLIVAN, PLAN II HONORS PROGRAM

- Jillian Brooke Examining and Increasing Customer Satisfaction Through Online Store Design
Supervisor: Kapil Jain, Marketing
- Alexander Clarke Viral Information Diffusion on Social Networks
Supervisor: Jorge Peña, Communications
- Jandy Gu Escaping Ephemerality: Digital Media and Interaction in the Texas Street Art Scene
Supervisor: Craig Campbell, Anthropology
- Alex Kwon Advancement of Technology and Modernization of Courtship in Korea
Supervisor: Robert M. Oppenheim, Asian Studies
- Linhao Zhang Sentiment Analysis on Twitter and Correlation with Stock Price and Significant Keywords
Supervisor: Inderjit Dhillon, Computer Science

4.3 America in/and History

CLA 0.126

MODERATOR: JULIE CASEY, HUMANITIES

- Gracie Fraser Redefining First Lady in Four Days: Lady Bird Johnson's Whistle Stop Tour
Supervisor: H. W. Brands, History
- Angus McLeod IV Robert C. Ogden: Proponent of Northern Philanthropy and the Education of
Blacks in the South at the Dawn of the Twentieth Century
Supervisor: Michael B. Stoff, History
- José Ordoñez The San Elizario Salt War
Supervisor: Erika Bsumek, History
- Sam Rhea Fueling the Flagship - The Management of Sovereign Wealth Funds for
Education in Texas
Supervisor: Michael B. Stoff, History
- Rishi Shah Human Capital and the Marshall Plan
Supervisor: H. W. Brands, History

4.4 Global Studies in Culture and Politics

CLA 0.112

MODERATOR: CYNTHIA FRANCICA, PLAN II HONORS PROGRAM

- Monica Attia Out of Egypt and Into the World: The Journey of Coptic Christians
Supervisor: William Nethercut, Classics
- Marc A. Alexander Next Year in Jerusalem? Assessing the Decline in Enrollment of Jewish
High-School Teenagers on Short-Term Summer Programs in Israel
Supervisor: Alexander Weinreb, Sociology
- Priya Prakash Rebuild and Reform: Health Care Advancements in Post-War El Salvador
Supervisor: Jacqueline Angel, Sociology
- Johann Roldan The Limits of Reform: Informal Public Transportation in Lima
Supervisor: Henry Dietz, Government
- Swati Verma The Birth of the Ayurvedic Doctor: Physicians in Training in Classical and
Contemporary India
Supervisor: Martha Selby, Asian Studies

4.5 Creative Theses II: Music and Drama

CLA 0.102

MODERATOR: JAMES LOEHLIN, ENGLISH

- Thaisa Howorth That Others May Live
Supervisor: Cindy McCreery, Radio Television Film
- Aneesa Gupta Needel Counterparts
Supervisor: Steven Dietz, Theatre and Dance
- Patrick Naeve William the Conqueror: A Verse History
Supervisor: James Loehlin, English
- Andy Webb Music Composition: Death and Love
Supervisor: Donald Grantam, Butler School of Music

4.6 Global Health and Human Rights

CLA 1.106

MODERATOR: STEPHEN SONNENBERG, ARCHITECTURE

- Molly Bates A Shot in the Dark: Understanding the Anti-Vaccine Movement and the Importance of Doctor-Patient Communication
Supervisor: Stephen Sonnenberg, Architecture
- Sonya Chung To Proclaim Liberty to the Captives: The Promise of Christianity for Human Rights in North Korea
Supervisor: Benjamin Gregg, Government
- Georgene Hergenroeder The Current State of Healthcare Coverage in Texas: An Investigation of the Impact of Coverage Expansion under the Affordable Care Act on Two Texas Healthcare Clinics
Supervisor: Henry Dietz, Government
- Sarah E. Wilbanks Sexual Assault and the Military Justice System
Supervisor: Stephen Sonnenberg, Architecture
- Megan Wolfrom Invisible Children: One Organization's Role in a Global Conflict
Supervisor: Thomas G. Palaima, Classics

Make-up Session Presenters

Due to unavoidable conflicts, the following students will present their senior thesis at a make-up session, to be scheduled for a later date:

Iman Khadija Berrahou El Ghorba: Songs of Exile in French and Maghreb Society
Supervisor: Benjamin Brower, History

Nick Lovitt Dispossession by Displacement
Supervisor: Catherine Boone, Government

Shivani Patel The WHO: Global Health Monitoring
Supervisor: William Winslade, Plan II Honors Program

Session Moderators

We are very grateful to those who served as session moderators at this symposium

Michael Adams	Austin Gleeson	Stanley Reiser
Michael Anderson	Penny Green	Ann Repp
Julie Casey	Beverly Hadaway	Mary Rose
Dana Cloud	Michael Harney	Daron Shaw
Judith Coffin	Kristine Hopkins	Stephen Sonnenberg
Brian Doherty	Coleman Hutchison	Paul Sullivan
Cynthia Francica	James Loehlin	William Winslade
	Robert Jensen	

Plan II Staff

Michael B. Stoff, Director
Alexandra K. Wettlaufer, Acting Director
Paul Sullivan, Assistant Director
Mary Dillman, Academic Advisor
Phillip Dubov, Alumni Liaison
Cynthia Francica, Teaching Assistant
Melissa Ossian, Academic Advisor
Elsie Reboloso, Office Manager
Jennifer Scalora, Admissions Director
Matt Valentine, Joynes Room Coordinator



MAP OF SESSION ROOM LOCATIONS

CLA BASEMENT ROOM LOCATIONS

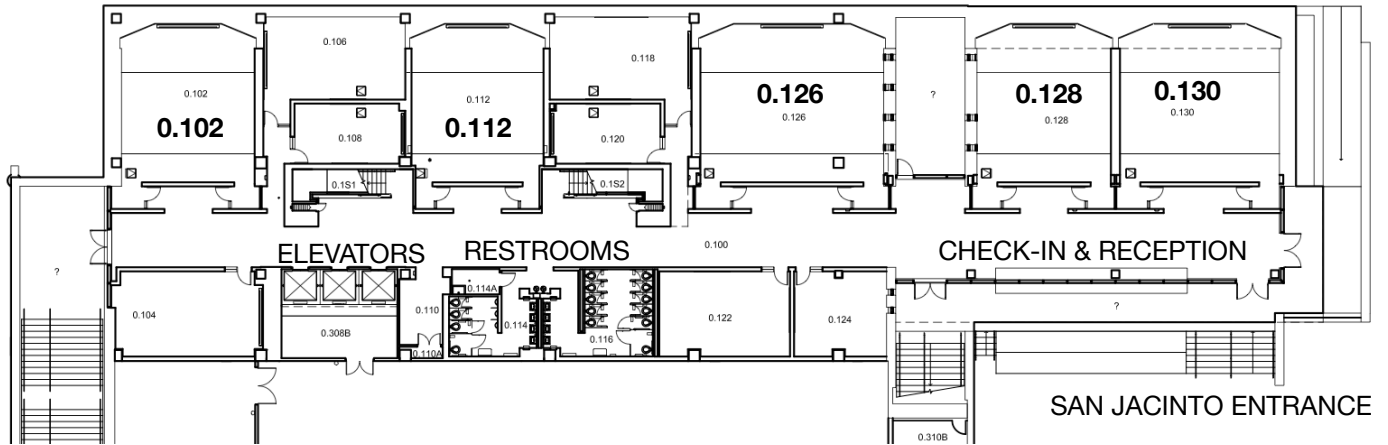

CLA FIRST FLOOR ROOM LOCATIONS

