

PLAN II FALL THESIS

# Symposium



NOVEMBER 10, 2013

## MAP OF SESSION ROOM LOCATIONS



## CONTENTS

2	The Day at a Glance
4	Alphabetical Index of Students with Session Number
5	Session One 1:00 p.m. - 2:30 p.m.
8	Session Two 2:45 p.m - 4:15 p.m.
9	Session Moderators, Plan II Staff
10	Map of Session room locations

### Participant and Moderator Check-In

Please pick up a name tag and program at the Plan II table  
outside CLA 0.130, 12:45 p.m. - 3:30 pm

Refreshments available next to check-in table, 12:45 p.m. to 3:30 p.m.

Compliments of Plan II Honors Program

# The Day at a Glance

## SESSION I

1:00 - 2:30 PM

**1.1 Art & Humanities**  
Moderator: Roanne Kantor

**CLA 0.130**

**1.2 Health & Psychology**  
Moderator: Paul Sullivan

**CLA 0.128**

## SESSION 2

2:45 - 4:15 PM

**2.1 Community, Identity & Policy**      **CLA 0.130**  
Moderator: Roanne Kantor

**2.2 Media & Society**      **CLA 0.128**  
Moderator: Paul Sullivan

**2.3 Modern Economies**      **CLA 0.126**  
Moderator: Michael B. Stoff

# Alphabetical Student Index with Session Number

Arena, Ian, 2.3

Boa, David Joseph, 2.2

Bower, Rachel, 1.2

Corley, Danielle, 2.1

Escalante, Adriana, 2.1

Fondren, Wren, 2.2

Gopal, Ritika, 2.1

Hardee, Garrett, 1.1

Harr, Amanda, 1.1

Howell, Erin, 2.1

Huang, Patty, 2.2

Jacobs, Austin M., 2.3

Jo, Hyung Mook, 1.2

LaValley, Meredith C., 1.1

Livieres, Stephanie Ingrid Ana, 2.3

Melhado, Christian, 1.1

Mendoza, Donald, 1.2

Parthiban, Vik, 1.1

Siegel, Claire, 2.2

Smartt, Tim, 1.2

Taraba, Matt, 2.3

Thompson, Chrissy, 2.1

Wham, Michael, 2.2

# Session One 1:00 - 2:30 p.m.

## 1.1 Arts & Humanities

CLA 0.130

MODERATOR: ROANNE KANTOR, PLAN II HONORS PROGRAM

- Amanda Harr                      Reflections Through A Broken Mirror: Growing up with a mentally retarded twin sister  
*Supervisor: Elizabeth McCracken, English*
- Garrett Hardee                    The Architectural Legacy of O'Neil Ford: Texas Vernacular or Critical Regionalism?  
*Supervisor: Lawrence Speck, Architecture*
- Meredith C. LaValley            Walden, the Wilderness and Water: An exploration of water as a means to explore the self in remote America  
*Supervisor: Evan Carton, English*
- Christian Melhado                The Deficiency of Offensive Realism Theory in a Post-State Modern World  
*Supervisor: George Christian, English*
- Vik Parthiban                      How Does One Connect to Modern Audiences through Informed Historical Performance Practice, from the Baroque to Romantic Periods?  
*Supervisor: Bryan Hall, Butler School of Music*

## 1.2 Health & Psychology

CLA 0.128

MODERATOR: PAUL SULLIVAN, PLAN II HONORS PROGRAM

- Rachel Bower                      Epigenetic and Neurological Transformations Associated with Eating Disorders  
*Supervisor: R. Adron Harris, Molecular Biology*
- Hyung Mook Jo                    MDMA-Assisted Therapy for Treating Anxiety and Depression: Targeting the Oxytocin System  
*Supervisor: Timothy Loving, Psychology*
- Donald Mendoza                  Placebo Effects in Pain Relief: Overview and Ethics  
*Supervisor: William Winslade, Plan II Honors*
- Tim Smartt                          Roses Are Red, Violets Are Blue, What Your Laughter Says About You  
*Supervisor: Samuel Gosling, Psychology*

# Session Two 2:45 - 4:15 p.m.

## 2.1 Community, Identity & Policy

CLA 0.130

MODERATOR: ROANNE KANTOR, PLAN II HONORS PROGRAM

- Adriana Escalante      Maintaining Indigenous Tradition in Protestant Guatemala  
*Supervisor: Virginia Garrard Burnett, Religious Studies*
- Ritika Gopal              Gender-Based Violence and National Security: The role of gender-based violence  
in predicting inter- and intrastate instability and why its countering should be the  
top action item on the U.S. national security agenda  
*Supervisor: Derek Jinks, School of Law*
- Erin Howell              Walking in Someone Else's Shoes: How Reading Fiction Influences  
Social Justice Values  
*Supervisor: Martin Kevorkian, English*
- Chrissy Thompson      Grade Retention and Academic Self-Concept in Middle School  
*Supervisor: Robert Croasnoe, Sociology*
- Danielle Corley          Do Women Make a Difference? The Impact of Pro-Choice Female Legislators  
on Texas Abortion Policy  
*Supervisor: Susan Marshall, Sociology*

## 2.2 Media & Society

CLA 0.128

MODERATOR: PAUL SULLIVAN, PLAN II HONORS PROGRAM

- David Joseph Boa      The Evolution and Progression of Communication Through Technology, Social Media, and the Smart Phone  
*Supervisor: Elizabeth Keating, Anthropology*
- Wren Fondren      Ins and Outs of Japanese Kogals: From Sexuality to Style  
*Supervisor: Kirsten Cather, Asian Studies*
- Patty Huang      The Role of Controversy in the Effectiveness of Cause-related Advertising  
*Supervisor: Sean Thompson, Advertising*
- Claire Siegel      Weighing the Options: The Effectiveness and Future of Online Weight Loss Programs  
*Supervisor: Sara Sweitzer, Nutrition*
- Michael Wham      The Impact of Digital Communication on Revolutionary Political Change  
*Supervisor: Austin Bay, Plan II Honors Program*

## 2.3 Modern Economies

CLA 0.126

MODERATOR: MICHAEL B. STOFF, PLAN II HONORS PROGRAM

- Ian Arena      The Possibility and Implications of Overheating in High-Yield Credit Markets  
*Supervisor: Jeremi Suri, LBJ School of Public Affairs*
- Austin M. Jacobs      Predatory Lending: A Comparative Critical Analysis of Microfinance and Payday Lending  
*Supervisor: James Galbraith, LBJ School of Public Affairs*
- Stephanie Ingrid Ana Livieres      US Fiscal Structure and the Prevalence of Fiscal Illusion  
*Supervisor: Valerie Bencivenga, Economics*
- Matt Taraba      Money Laundering and the Drug Trade  
*Supervisor: Michael Lauderdale, Social Work*

# Session Moderators

We are very grateful to those who served as session moderators at this symposium

Roanne Kantor  
Michael B. Stoff  
Paul Sullivan

## Plan II Staff

Michael B. Stoff, Director  
Alexandra K. Wettlaufer, Associate Director  
Paul Sullivan, Assistant Director

Mary Dillman, Academic Advisor  
Phillip Dubov, Alumni Liaison  
Roanne Kantor, Teaching Assistant  
Melissa Ossian, Academic Advisor  
Elsie Reboloso, Office Manager  
Jennifer Scalora, Admissions Director  
Matt Valentine, Joynes Room Coordinator





# MAP OF SESSION ROOM LOCATIONS

## CLA BASEMENT ROOM LOCATIONS

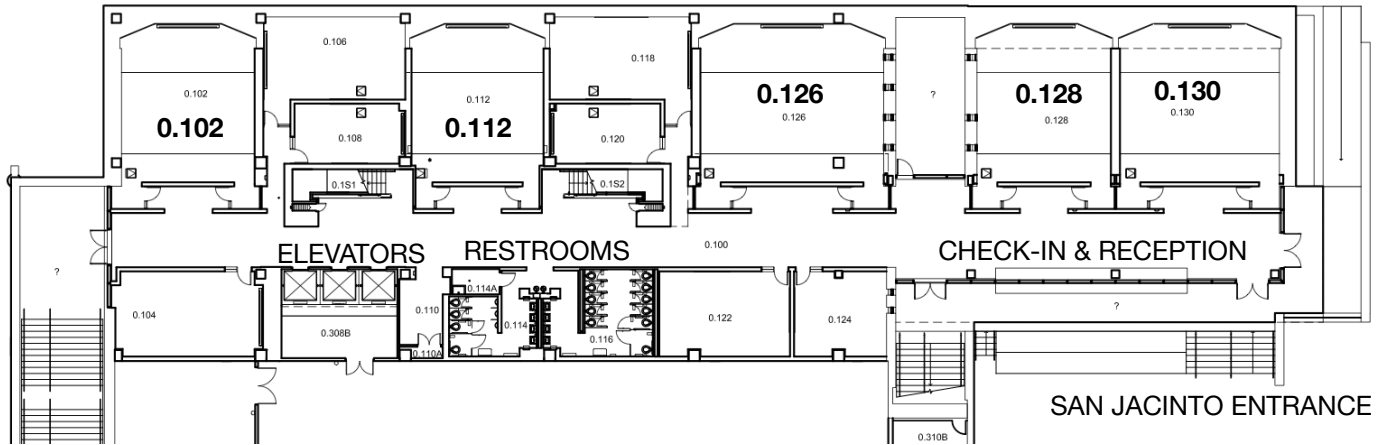

## CLA FIRST FLOOR ROOM LOCATIONS

