

PLAN II SPRING THESIS

Symposium



APRIL 19, 2015



CONTENTS

2	The Day at a Glance
4	Alphabetical Student Index with Session Number
5	Session One 10:15 a.m. - 11:45 a.m.
8	Session Two 12:00 p.m - 1:30 p.m.
11	Session Three 1:45 p.m - 3:15 p.m.
15	Session Four 3:30 p.m. - 5:00 p.m.
19	Make-up Session Presenters
20	Session Moderators, Plan II Staff
21	Map of Session room locations

Participant and Moderator Check-In

Please pick up a name tag and program at the Plan II table outside
CLA 0.130, 10 a.m.- 3:30 p.m.

Refreshments available next to check-in table, 10:00 a.m. - 4:00 p.m.

Compliments of Plan II Honors Program

The Day at a Glance

SESSION I

10:15 A.M. - 11:45 A.M.

- 1.1 Government:
Campaigns/Laws/Reforms** **CLA 0.130**
Moderator: Daron Shaw
- 1.2 Food & Culture** **CLA 0.128**
Moderator: Melanie Haupt
- 1.3 Social Problems & Solutions** **CLA 0.126**
Moderator: Rebecca M. Torres
- 1.4 Ecotourism/Conservation/Policy** **CLA 0.112**
Moderator: Ruth Buskirk
- 1.5 Music: Appreciation/
Education/Creativity** **CLA 0.102**
Moderator: George Christian
- 1.6 Energy & Natural Resources** **CLA 1.106**
Moderator: Carey King

SESSION 2

12:00 P.M. - 1:30 P.M.

- 2.1 International Identities** **CLA 0.130**
Moderator: Hannah Wojciehowski
- 2.2 Humanities & Healthcare** **CLA 0.128**
Moderator: Stephen Sonnenberg
- 2.3 Psychology, Health &
Relationships** **CLA 0.126**
Moderator: Wendy Domjan
- 2.4 Business Strategies** **CLA 0.112**
Moderator: Kate Gillespie
- 2.5 Art & Art History** **CLA 0.102**
Moderator: Joan Holladay
- 2.6 Science & Technology** **CLA 1.106**
Moderator: Joseph Beaman

The Day at a Glance

SESSION 3

1:45 P.M. - 3:15 P.M.

- | | |
|-------------------------------------------------------------------------|------------------|
| 3.1 War, Strategy & Security
Moderator: Michael B. Stoff | CLA 0.130 |
| 3.2 Conflict, Religion & Memory
Moderator: Tom Palaima | CLA 0.128 |
| 3.3 Issues in Public Health
Moderator: Alfred McAlister | CLA 0.126 |
| 3.4 International Opportunities
Moderator: John N. Doggett | CLA 0.112 |
| 3.5 Stories & their Significance
Moderator: Mia Carter | CLA 0.102 |
| 3.6 Advances in Engineering
Moderator: Cynthia Francica | CLA 1.106 |
| 3.7 Geology & Marine Science
Moderator: Julianna Leachman | CLA 1.104 |

SESSION 4

3:30 P.M. - 5:00 P.M.

- | | |
|-----------------------------------------------------------------------------|------------------|
| 4.1 History, Identity & Culture
Moderator: Bruce Hunt | CLA 0.130 |
| 4.2 Healthcare: Yesterday & Today
Moderator: William Winslade | CLA 0.128 |
| 4.3 Human & Civil Rights
Moderator: Robert Duvic | CLA 0.126 |
| 4.4 Narratives, Film & Photography
Moderator: Matt Valentine | CLA 0.112 |
| 4.5 Latin America: New Visions
Moderator: Cynthia Francica | CLA 0.102 |
| 4.6 Studying Social Trends
Moderator: Julianna Leachman | CLA 1.106 |
| 4.7 Biological Sciences
Moderator: Megan Raby | CLA 1.104 |

Alphabetical Student Index with Session Number

- Albrecht, Alan, 1.2
Arnold, Kristen, 4.6
Ashbaugh, Carson, 1.6
Azimpoor, Kian, 4.2
Baker, Dudley, 1.4
Barretto, Chantelle, 3.4
Baughn, Bevin, 1.5
Baumgartner, Michael, 4.7
Biggs, Grace, 4.2
Bindeman, Kris, 1.1
Bolster, Kenneth M., 4.7
Bryce, Mary, 1.2
Bui, Brina, 2.2
Burchard, Nathan T., 4.5
Caplan, Koby, 4.2
Carter, Murphy Anne, 3.5
Chupin, Daniel, 2.6
de Souza, Tania Maria Lucas, 4.5
Dean-Jones, Ciaran, 3.2
Dinderman, Dalton, 2.6
Dominguez, Jose, 3.3
Douglas, Sarah, 3.7
Ellis, Caroline, 4.3
Faires, Rosalind, 1.2
Fernandez, Anthony, 1.1
Floyd, Katie, 2.5
Ford, Aimee, 3.7
Garg, Nikhil, 2.6
George, Taylor, 4.4
Gourisankar, Sai, 3.6
Greenberg, Jordan, 2.5
Grigg, Neil, 2.3
Gruener, Emily, 3.1
Gustafson, Trey, 3.1
Hansen, Helen, 2.5
Harakal, Callie, 4.6
Harman, Colin, 1.5
Hoefler, Sharon, 1.3
Holstine, Jane M., 1.6
Hong, Judy, 2.1
Horton, Ellen, 1.3
Hudock, Marigold Mai, 3.5
Hunt, Crawford, 4.6
Imam, Jauzey, 2.1
Jbeily, Mark K., 3.1
Johnson, Becca, 1.3
Johnson, Ben, 4.1
Johnson, Jennifer K., 1.1
Johnson, Megan, 1.2
Jolink, Tatum, 2.3
Jolink, Willa, 3.3
Jones, Melissa, 1.4
Ken, Jack, 4.4
Kinscherff, Joanna, 3.5
Klein, Carly, 4.3
Kruijs, Nicole, 3.3
Lemens, Thomas, 2.4
Levesque, Taylor, 4.6
Lin, Jerry, 4.4
Long, Annie, 1.2
Maher, Sam, 1.4
Maidenberg, Tori, 3.2
Malya, Anuradha, 2.2
Mandalapu, Rohit, 2.1
Masada, Kendall, 2.3
McBee, Ross, 1.6
McConn, Molly Bridget, 2.4
Meeks, Kristin Michelle, 4.3
Metaxas, Athena E., 3.6
Michael, Ellis, 2.6
Miller, Isabel, 4.3
Modrall, Carson, 3.2
Moore IV, Preston, 1.6
Munoz, Ilse M., 4.5
Muñoz, Nicolas, 3.3
Naylor, Brooks, 3.5
Nickell, Logan Marlow, 4.1
O'Hara, Chelsea Vale, 1.1
Olmsted, Randall, 1.3
Onuigbo, Andrea, 1.1
Onyeka, Cynthia, 2.3
Patel, Jay, 3.1
Poirot, Collin, 3.4
Popat, Shyam, 4.2
Powell, Evelyn M., 3.7
Quddus, Sadia, 2.1
Quist, Rachel, 2.5
Robbins, Blair, 3.4
Saastamoinen, Sara Maaria, 4.1
Sackley, Kelly, 4.3
Salzer, Ian Bernard, 1.6
Schill, Alexia, 4.7
Schweinfurth, Will, 2.2
Seto, Isabelle, 4.5
Shankar, Priya, 3.4
Sher, Soa-Jin, 3.6
Shi, Linda, 2.1
Shukla, Mihir, 2.2
Simerly, Alison, 1.4
Smith, Andrew, 4.1
Solomon, Rachel, 2.4
Sone, Margaret, 2.5
Spangler, Jacob, 2.4
Spiser, Katherine, 3.3
Stacy, Katie, 3.5
Stein, Jennifer, 4.6
Sturrock, Colin, 3.7
Sulentic, Rose, 1.6
Sur, Aakash, 4.7
Taylor, Brian, 1.5
Walters, Edgar, 4.4
Wang, Lillian, 2.3
Wang, Daniel, 3.2
Wellik, Margaret, 1.3
Wijesinghe, Dinusha, 2.4
Wolford, Alexandra, 4.4
Work, Tiffany, 4.2
Yao, Ruyi, 3.4
Zetzman, Beth, 2.6

Session One 10:15 - 11:45 a.m.

1.1 Government: Campaigns/Laws/Reforms

CLA 0.130

MODERATOR: DARON SHAW, GOVERNMENT

- Kris Bindeman The Golden Circle – How Branding Affects the Fate of Political Campaigns
Supervisor: Daron Shaw, Government
- Anthony Fernandez Colorado's Choice: Excise Tax Policy and Legislative Intent
Supervisor: John Robinson, Accounting
- Jennifer K. Johnson Moskva Daleko (Moscow is Far Away): Ethnic Federalism in Putin's Russia
Supervisor: Robert Moser, Government
- Chelsea Vale O'Hara Assessing Article V of the U.S. Constitution: The Value of the Formal Amendment Process
Supervisor: Gary Jacobsohn, Government
- Andrea Onuigbo Closing the Gender Gap in Women's Representation in Public Office: Examining Methods to Recruit Female Candidates
Supervisor: Bethany Albertson, Government

1.2 Food & Culture

CLA 0.128

MODERATOR: MELANIE HAUPT, RHETORIC & WRITING

- Alan Albrecht Fighting Food, Inc.: The Value of the Organic Food Industry
Supervisor: Nancy Stalker, Asian Studies
- Mary Bryce The Food Goddess: Recipes, Stories, and the 5 Women Who Changed How America Eats
Supervisor: Melanie Haupt, Rhetoric & Writing
- Rosalind Faires Dinner Party Macbeth: Food, Hospitality, and Gender in a Production of Shakespeare's Tragedy
Supervisor: Sarah Rasmussen, Theatre & Dance
- Megan Johnson From Julia to Giada: The Social Implications of Culinary Television
Supervisor: Nancy Stalker, Asian Studies
- Annie Long New Orleans Food Culture Since Hurricane Katrina: How Restaurants Breathed Life Back Into NoLa
Supervisor: Nancy Stalker, Asian Studies

1.3 Social Problems & Solutions

CLA 0.126

MODERATOR: REBECCA M. TORRES, GEOGRAPHY & THE ENVIRONMENT

- Sharon Hoefler Worth the Wait? The Consequences of Abstinence-Only Sex Education for Texas Students
Supervisor: Cynthia Franklin, Social Work
- Ellen Horton Juvenile Delinquency: The Gray Line of Justice
Supervisor: William Kelly, Sociology
- Becca Johnson The Austin Single-Sex School Debate: How Do Key Players Make Single-Sex Education Decisions?
Supervisor: Mary Rose, Sociology
- Randall Olmsted Unban the Blood: Gay Men, Blood Donation, and an Outdated Public Health Response to HIV/AIDS
Supervisor: Shannon Cavanagh, Sociology
- Margaret Wellik Unintentional Subsidies: Charity in the Farmers' Markets
Supervisor: Rebecca M. Torres, Geography & the Environment

1.4 Ecotourism/Conservation/Policy

CLA 0.112

MODERATOR: RUTH BUSKIRK, MOLECULAR BIOSCIENCES

- Dudley Baker A Policy Analysis: Texas Parks and Wildlife Funding Issues – The Debate Between Governmental and Nongovernmental Management Strategies
Supervisor: Ruth Buskirk, Molecular Biosciences
- Melissa Jones Regulating the Shark Fin Trade Through Legislation and International Cooperation
Supervisor: Susan Hightower, School of Law
- Sam Maher Closing the Gap: Eco-Tourism as an Intermediary between Local & International Conservation Efforts
Supervisor: Thoralf Meyer, Geography & the Environment
- Alison Simerly Invasion on the Texas Coast: Monitoring the Distribution of the Non-native Brazilian Peppertree and its Impact on Ecosystem Function
Supervisor: Kenneth Young, Geography & the Environment
- Rose Sulentic The Meaning of Open Space: The Role of Land Trusts in Public Health
Supervisor: Kelley Crews, Geography & the Environment

1.5 Music: Appreciation & Education

CLA 0.102

MODERATOR: GEORGE CHRISTIAN, ENGLISH

- Bevin Baughn Myth, Magic, and Music: The Ways in Which Good and Evil Are Represented through the Harry Potter Soundtracks
Supervisor: James Buhler, Butler School of Music
- Colin Harman Young God: A Musical Adaptation of Milton's Paradise Lost
Supervisor: George Christian, English
- Brian Taylor Music Competition and Motivation: How the State of Competition Affects Intrinsic Motivation in Secondary Music Students
Supervisor: Robert Duke, Butler School of Music

1.6 Energy/Natural Resources

CLA 1.106

MODERATOR: CAREY KING, ENERGY INSTITUTE

- Carson Ashbaugh Contextualizing the Twenty-First Century Oil Boom in the Lone Star State
Supervisor: Carey King, Energy Institute
- Jane M. Holstine Oil, Gas, and Water: Strategies to conserve water in Texas' drilling industry
Supervisor: James D. Miller, Finance
- Ross McBee The Economics of Microbial Fuel Cells
Supervisor: David J. Eaton, LBJ School of Public Affairs
- Preston Moore IV Analyzing the BP Oil Spill and its Corresponding Effects on the Oil & Gas Industry and on Stakeholders Worldwide
Supervisor: Laura Starks, Finance
- Ian Bernard Salzer Induced Innovation in the Automotive Industry
Supervisor: Valerie Bencivenga, Economics

Session Two 12:00 - 1:30 p.m.

2.1 International Identities

CLA 0.130

MODERATOR: HANNAH WOJCIEHOWSKI, ENGLISH

- Judy Hong The Expansion of the Blogosphere: The Effects on South Korean and U.S. Mainstream Media, Culture, and Society
Supervisor: Hannah Wojciehowski, English
- Jauzey Imam A Networked Colonialism: the Use of Network Structures in the Israeli Occupation of Palestine
Supervisor: Simone Browne, African & African Diaspora Studies Department
- Rohit Mandalapu Understanding India's Liberalization: A Case Study of India's License Raj and Its Effects
Supervisor: Valerie Bencivenga, Economics
- Sadia Quddus The Western Mosque: A Reading of Architectural Articulations of Power
Supervisor: Denise Spellberg, History
- Linda Shi A Spain Fragmented: Conflict of National and Regional Identities and the Constitution of 1978
Supervisor: Michael Harney, Spanish

2.2 Humanities & Healthcare

CLA 0.128

MODERATOR: STEPHEN SONNENBERG, ARCHITECTURE

- Brina Bui Pediatric Hospitals: The Intersection Between Art and Medicine
Supervisor: Stephen Sonnenberg, Architecture
- Anuradha Malya The Hypocritical Oath: Physicians are Human, Too
Supervisor: Stephen Sonnenberg, Architecture
- Will Schweinfurth Better Medicine and Better Doctors Through Information Technology
Supervisor: Stephen Sonnenberg, Architecture
- Mihir Shukla Health, Harm, and Happiness: An Examination of John Stuart Mill's Influence on the Development of Public Health
Supervisor: Stephen Sonnenberg, Architecture

2.3 Psychology, Health & Relationships

CLA 0.126

MODERATOR: WENDY DOMJAN, PSYCHOLOGY

- Neil Grigg Twitter for Large-Scale Mental Health Monitoring
Supervisor: James Pennebaker, Psychology
- Tatum Jolink Should I Stay? Infidelity and the Implicit Theory of Relationships
Supervisor: Paul Eastwick, Human Development & Family Sciences
- Kendall Masada Dancing the Way to Empathy: An Investigation and Experimental Proposal for How Dance Can Be Used to Foster Empathy in Children with Attention-Deficit Hyperactivity Disorder
Supervisor: Jerome Bump, English
- Cynthia Onyeka Don't Call the Witch Doctor: An Examination of the Developing Public Mental Health Services in Southeastern Nigeria
Supervisor: Kirsten Bradbury, Psychology
- Lillian Wang The Bicultural Mind: How the Convergence of Two Cultures Influences Attribution in Second-Generation Chinese Americans
Supervisor: Wendy Domjan, Psychology

2.4 Business Strategies

CLA 0.112

MODERATOR: KATE GILLESPIE, MARKETING

- Thomas Lemens Kickstarting Innovation: An Analysis of Intellectual Property Creation and Value Appropriation Techniques Among Knowledge-Based Business Organizations
Supervisor: Hüseyin Tanriverdi, Information, Risk, and Operations Management
- Molly Bridget McConn Speaking the 'Like' Language: A Case Study Analysis of Effective Visual Company Culture Communication Online to Attract Millennial Recruits
Supervisor: Robert Quigley, Journalism
- Rachel Solomon Austin, TX: The Heart of Music, Technology, and... Fashion? A Comparative Analysis with the New York City and Los Angeles Fashion Industries
Supervisor: Stephen Walls, Marketing
- Jacob Spangler LBJ's Power and Persuasion: A Lesson for the Present-Day Business Leader
Supervisor: Caroline Bartel, Management
- Dinusha Wijesinghe "Made in Sri Lanka": An Examination of Sri Lanka's Role in the Global Apparel Value Chain and Implications for International Trade Relations
Supervisor: Kate Gillespie, Marketing

2.5 Art & Art History

CLA 0.102

MODERATOR: JOAN HOLLADAY, ART & ART HISTORY

- Katie Floyd Nuancing a Narrative: An In-Depth Look at Preclassic Olmec-Style Crouching Figures
Supervisor: Julia Guernsey, Art & Art History
- Jordan Greenberg Temporality and Palestinian Cultural Production: Trauma, History, and Politics in Palestinian Art and Writing after the Second Intifada
Supervisor: Tarek El Ariss, Comparative Literature
- Helen Hansen Eleanor of Aquitaine: Art Patronage and Political Power in Medieval France and England
Supervisor: Joan Holladay, Art & Art History
- Rachel Quist The Power of the Collection: Impressions of Buddhism through the Museum Lens
Supervisor: Janice Leoshko, Art & Art History
- Margaret Sone Revelations from a Naughty Postcard: How Renaissance Portraiture, Contemporary Photographic Portraiture, and Orientalist Painting Shaped French Ethnographic Photography in the Era of Imperialism
Supervisor: Ann Johns, Art & Art History

2.6 Science & Technology

CLA 1.106

MODERATOR: JOSEPH BEAMAN, MECHANICAL ENGINEERING

- Daniel Chupin K-Theory and the Heat Kernel: Methods of Proof for the Atiyah-Singer Index Theorem
Supervisor: Andrew Neitzke, Mathematics
- Dalton Dinderman Perspectives on 3-D Printing: A Close Examination of Legal, Ethical, and Social Activity
Supervisor: Joseph Beaman, Mechanical Engineering
- Nikhil Garg Densification in the Design of Next-Generation Wireless Networks
Supervisor: Jeffrey Andrews, Electrical & Computer Engineering
- Ellis Michael Scaling Leader-Based Protocols for State Machine Replication
Supervisor: Lorenzo Alvisi, Computer Science
- Beth Zetzman The Effect of Reactive Aggregate Size on ASR-Related Expansion in Concrete
Supervisor: Oguzhan Bayrak, CAEE, Structural Engineering

Session Three 1:45 - 3:15 p.m.

3.1 War, Strategy & Security

CLA 0.130

MODERATOR: MICHAEL B. STOFF, HISTORY

- Emily Gruener National Security v. Civil Liberties: The Future of Mass Surveillance in the United States
Supervisor: Jeffrey Abramson, Government
- Trey Gustafson Cooperation, Arms, and War
Supervisor: Terrence Chapman, Government
- Mark K. Jbeily "This Nation Will Act": Preventive War Under Bush and Obama
Supervisor: Jeremi Suri, LBJ School of Public Affairs
- Jay Patel An Analysis of a Supreme Court Ruling: Equipping a Vested Citizen with Precedence
Supervisor: H. W. Brands, History

3.2 Conflict, Religion, & Memory

CLA 0.128

MODERATOR: TOM PALAIMA, CLASSICS

- Ciaran Dean-Jones "Woe Unto the World Because of Offenses": The Wartime Theology of Abraham Lincoln
Supervisor: Tom Palaima, Classics
- Tori Maidenberg An Antidote to Death: The Nature of Holocaust Memory in Israeli Society
Supervisor: Stephen Sonnenberg, Architecture
- Carson Modrall But God Said I Could: A Cross-Examination of American Religious Institutions Regarding Domestic Violence and Civil Authority
Supervisor: Jennifer Graber, Religious Studies
- Daniel Wang Violence in Verse: The Innovations and Wisdom of Wilfred Owen
Supervisor: Stephen Sonnenberg, Architecture

3.3 Issues in Public Health

CLA 0.126

MODERATOR: ALFRED MCALISTER, PLAN II HONORS PROGRAM PROGRAM

- Jose Dominguez *Deus Ex Medicina: Navigating Ethical Conflicts and their Resolutions between Catholic Ethics and Secular Healthcare Needs in Catholic Hospitals*
Supervisor: Alfred McAlister, Plan II Honors Program
- Willa Jolink *A History of Clean Needle Exchange Programs: What Texas Needs to Get It Done*
Supervisor: Stanley Reiser, Plan II Honors Program
- Nicole Kruijs *Healthcare Financing: A Comparative Analysis of World Financing Systems and Links to Healthcare Outcomes*
Supervisor: Alfred McAlister, Plan II Honors Program
- Nicolas Muñoz *Advanced Care Planning: A Plan for Greater Use*
Supervisor: Alfred McAlister, Plan II Honors Program
- Katherine Spiser *New Media for Health Information and the Changing Practice of Medicine*
Supervisor: Stanley Reiser, Plan II Honors Program

3.4 International Opportunities

CLA 0.112

MODERATOR: JOHN N. DOGGETT, MANAGEMENT

- Priya Shankar *Panacea or Poverty Trap: An Economic and Ethnographic Exploration of Microfinance in India*
Supervisor: Heather Hindman, Asian Studies
- Chantelle Barretto *An Ocean of Opportunity: Creating Zero-Emission Freshwater in Gujarat, India by Harnessing Hydrokinetic Energy*
Supervisor: John N. Doggett, Management
- Collin Poirot *(De)constructing Arctic Geopolitics: A Critical Interrogation of International Environmental Politics in Light of Climate Change*
Supervisor: Michael Mosser, Government
- Blair Robbins *Volunteer Tourism: Giving Back in the Global Era*
Supervisor: Diane Rhodes, Social Work
- Ruyi Yao *Exploring the Phenomenon of American English Teachers in South Korea*
Supervisor: Heather Hindman, Asian Studies

3.5 Stories & their Significance

CLA 0.102

MODERATOR: MIA CARTER, ENGLISH

- Brooks Naylor "The Play's the Thing": Shakespeare's Influence on the Stoppard Canon
Supervisor: James Loebelin, English
- Murphy Anne Carter Reading Between Notes: Jazz in Julio Cortázar's "The Pursuer"
Supervisor: Mia Carter, English
- Marigold Mai Hudock Exploring Trauma-Digestion in Modern Child Soldier Narratives
Supervisor: Mia Carter, English
- Joanna Kinscherff The Galápagos Islands in Fiction
Supervisor: Neville Hoad, English
- Katie Stacy Hellish Science, Medicines of Might: The Use of Witchcraft in The Faerie Queene
to Resurrect the Dead and Animate the Non-living
Supervisor: J.K. Barret, English

3.6 Advances in Engineering

CLA 1.106

MODERATOR: CYNTHIA FRANCICA, PLAN II HONORS PROGRAM

- Athena E. Metaxas Synthesis and Characterization of Superparamagnetic Iron Oxide Nanoparticles
(SPIONs)
Supervisor: Keith P. Johnston, Chemical Engineering
- Soa-Jin Sher Luminescent CuInSe₂-Based Core/Shell Nanocrystals: Characterizing Defects
in CuInSe₂ Nanocrystals
Supervisor: Brian Korgel, Chemical Engineering
- Sai Gourisankar Gold "NanoBevos" for Biomedical Imaging Applications
Supervisor: Keith P. Johnston, Chemical Engineering

3.7 Geology & the Environment

CLA 1.104

MODERATOR: JULIANNA LEACHMAN, PLAN II HONORS PROGRAM

- Sarah Douglas The Sea In-Situ: Using Immersive Experiences to Further the Field of Oceanography
Supervisor: Ken Dunton, Marine Science
- Aimee Ford Factors Controlling Dissolved Oxygen Concentration Induced by Fish Nests in the Hyporheic Zone of Stream Beds
Supervisor: M. Bayani Cardenas, Geological Sciences
- Evelyn M. Powell Improving the Positioning of a 1987 Airborne Survey Conducted over Whillans Ice Sheet, Antarctica
Supervisor: Donald D. Blankenship, Geological Sciences
- Colin Sturrock Slipping Through the Cracks: Fluid flow through fractured carbonates along the North Anatolian Fault, Turkey
Supervisor: Elizabeth J. Catlos, Geological Sciences

Session Four 3:30 - 5:00 p.m.

4.1 History, Identity & Culture

CLA 0.130

MODERATOR: BRUCE HUNT, HISTORY

- Ben Johnson "This is Country": Idealization in Hemingway's 20th Century Spain
Supervisor: James Cox, English
- Logan Marlow Nickell An American Abroad: A social and political history of the July Crisis understood through the travel diary of Daisy Congdon
Supervisor: Austin Bay, Plan II Honors Program
- Sara Maaria Saastamoinen From Russia with Aston Martins, Martinis, and More Toast: Examining Luxury and Leisure in the Lives of James Bond and Ian Fleming and Consumer Behavior in the United Kingdom and the United States from the 1950s to the 2000s
Supervisor: David L. Leal, Government
- Andrew Smith Science Skirmishes: Who Really Receives Credit for Scientific Discoveries?
Supervisor: Bruce Hunt, History

4.2 Healthcare: Yesterday & Today

CLA 0.128

MODERATOR: WILLIAM WINSLADE, PHILOSOPHY

- Kian Azimpoor Racial and Ethnic Minority Healthcare Disparities in the U.S. Healthcare System: An Ethical and Pragmatic Analysis
Supervisor: Kenneth Shine, Plan II Honors Program
- Grace Biggs Healthcare in America & The Long Term Efficacy of Accountable Care Organizations
Supervisor: Richard Nauert, College of Natural Sciences
- Koby Caplan Perspectives in Palliative Care: the Present, the Future, and Ethical Issues of End-of-Life Medicine
Supervisor: Brian Bremen, English
- Shyam Popat Concussions, Football Culture, and the League of Denial: The Current and Future State of American Football
Supervisor: William Winslade, Philosophy
- Tiffany Work A Vertical View of the Medical Profession in Ancient Rome
Supervisor: Karl Galinsky, Classics

4.3 Human & Civil Rights

CLA 0.126

MODERATOR: ROBERT DUVIC, FINANCE

- Caroline Ellis Better for the Assaulted, Worse for the Assailant: How Federal Firearm Policy Can Reduce Criminal Gun Violence in America
Supervisor: Alan Sager, Government
- Carly Klein Eleanor Roosevelt and the Universal Declaration of Human Rights
Supervisor: Zachary Elkins, Government
- Kristin Michelle Meeks Corporate Personhood: Citizens United v. FEC and Burwell v. Hobby Lobby Stores, Inc.
Supervisor: Jeffrey Abramson, Government
- Isabel Miller Women's Changing Employment Opportunities in Urban China After 1978
Supervisor: Robert Duvic, Finance
- Kelly Sackley The Impact of Second Wave Feminism on Psychiatric Law
Supervisor: Katherine Arens, Germanic Studies

4.4 Narratives, Film & Photography

CLA 0.112

MODERATOR: MATT VALENTINE, PLAN II HONORS PROGRAM

- Taylor George The Politics of Medium: The "Literary" and the "Cinematic" in the Work of Graham Greene
Supervisor: Neil Nehring, English
- Jack Ken Austinities: A Short Story Collection
Supervisor: Matt Valentine, Plan II Honors Program
- Jerry Lin Two-Dimensional Memorial Exhibitions: A Comparative Analysis of the Tuol-Sleng Portraits and Ai Weiwei's "According to What?" Sichuan Name List.
Supervisor: Matt Valentine, Plan II Honors Program
- Edgar Walters Dry Spell: Will Wichita Falls, Texas Survive The Worst Drought in History?
Supervisor: Greg Curtis, Liberal Arts Honors
- Alexandra Wolford Sorry I'm Late, I Didn't Want to Come: Exploring Hegemonic Representations of Millennial Women in Theatre, Film, and Television
Supervisor: Laquetta Carpenter, Theatre & Dance

4.5 Latin America: New Visions

CLA 0.102

MODERATOR: CYNTHIA FRANCICA, PLAN II HONORS PROGRAM

- Nathan T. Burchard Realizing Notorious Potential: Brazil's Foreign Policy Quest
Supervisor: Kurt Weyland, Government
- Tania Maria Lucas de Souza Skilled Transnational Spaces: Networks, Identities, and Trajectories of Latin American Chemical Engineers
Supervisor: Gregory W. Knapp, Geography & the Environment
- Ilse M. Munoz INGOs and Culture: Preserving the Culture of Xochimilco in the 21st Century
Supervisor: William Doolittle, Geography & the Environment
- Isabelle Seto Mexico's Oaxaca: The Impact of Tourism on Native Representations
Supervisor: Susan Deans-Smith, History

4.6 Studying Social Trends

CLA 1.106

MODERATOR: JULIANNA LEACHMAN, PLAN II HONORS PROGRAM

- Kristen Arnold Bringing Down Whooping Cough: A Reevaluation of the Current Approach to the Pertussis Epidemic in the United States
Supervisor: Jennifer Maynard, Chemical Engineering
- Callie Harakal Why Diets Stop Working: Analyzing the Long-Term Effects of Restricted-Calorie Dieting in the U.S.
Supervisor: Lydia Steinman, Nutritional Sciences
- Crawford Hunt Mapping Austin's No Kill Network
Supervisor: Amon Burton, School of Law
- Taylor Levesque The New Timeline of College Football: High-School Recruit Self-Presentation on Twitter
Supervisor: Emily Sparvero, Kinesiology & Health Education
- Jennifer Stein The Problem of Sustainable Building Codes in the US: Architects as Designers of Sustainable Building Legislation
Supervisor: Matthew Fajkus, Architecture

4.7 Biological Sciences

CLA 1.104

MODERATOR: MEGAN RABY, HISTORY

- Michael Baumgartner *Models and Model Making in Biology: How Scientific Knowledge is Shaped by the Organisms and Devices in the Lab*
Supervisor: Megan Raby, History
- Kenneth M. Bolster *Molecular Upheavals: How the History of Life on Earth Informs the Search for Extraterrestrial Intelligence*
Supervisor: David W. Hoffman, Molecular Biosciences
- Alexia Schill *Antibiotic Resistance: The 'Epidemic' of Modern Medicine*
Supervisor: Mona Mebdy, Molecular Biosciences
- Aakash Sur *Metabolic Engineering of Geobacillus*
Supervisor: Alan Lambowitz, Molecular Biosciences

Make-up Session Presenters

Due to unavoidable conflicts, the following students will present their senior thesis at a make-up session, to be scheduled for a later date:

- Emily Elizabeth Mixon A MODIS-based Examination of Annual Burned Area and Photosynthetic Response to Seasonal Fire One Year Post Burn in Southern Africa's Miombo Woodland Belt
Supervisor: Throalf Meyer, Geography and The Environment
- Sarah Elizabeth White Elizabeth Carpenter, a Biography
Supervisor: H. W. Brands, History

Session Moderators

We are very grateful to those who served as session moderators at this symposium

Joseph Beaman

Ruth Buskirk

Mia Carter

George Christian

John N. Doggett

Wendy Domjan

Robert Duvic

Cynthia Francica

Kate Gillespie

Melanie Haupt

Joan Holladay

Bruce Hunt

Carey King

Julianna Leachman

Alfred McAlister

Tom Palaima

Megan Raby

Daron Shaw

Stephen Sonnenberg

Michael B. Stoff

Rebecca M. Torres

Matt Valentine

William Winslade

Hannah Wojciehowski

Plan II Staff

Michael B. Stoff, Director

Alexandra K. Wettlaufer, Associate Director

Richard Reddick, Assistant Director

Mary Dillman, Academic Advisor

Phillip Dubov, Alumni Liaison

Cynthia Francica, Teaching Assistant

Julianna Leachman, Teaching Assistant

Melissa Ossian, Academic Advisor

Elsie Reboloso, Office Manager

Kerry Pasquale, Admissions Director

Matt Valentine, Joynes Room Coordinator



CLA BASEMENT ROOM LOCATIONS

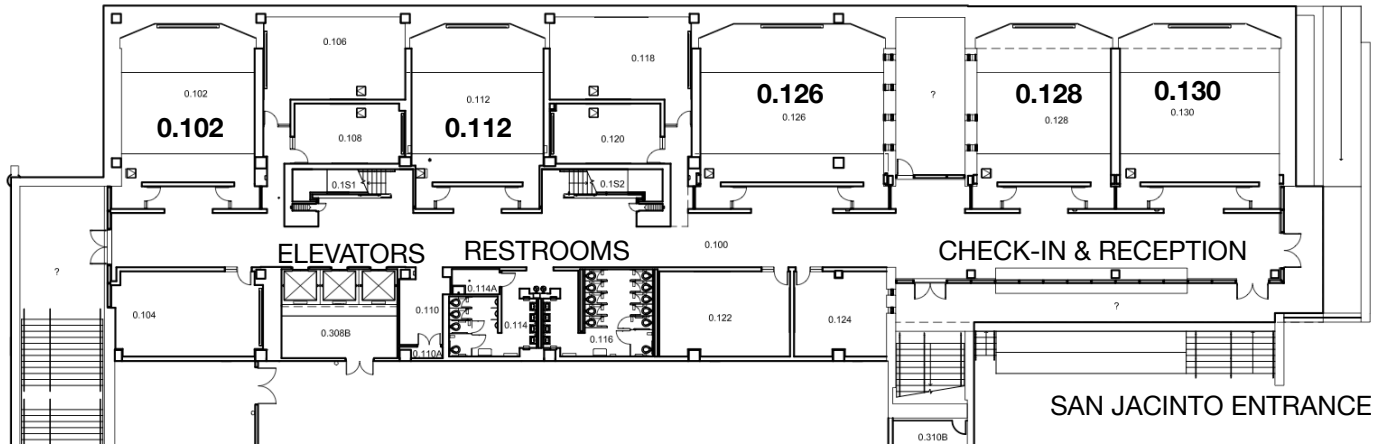

CLA FIRST FLOOR ROOM LOCATIONS

