

PLAN II SPRING THESIS

Symposium



APRIL 17, 2016



CONTENTS

2	The Day at a Glance
4	Alphabetical Student Index with Session Number
5	Session One 10:15 a.m. - 11:45 a.m.
8	Session Two 12:00 p.m - 1:30 p.m.
13	Session Three 1:45 p.m - 3:15 p.m.
17	Session Four 3:30 p.m. - 5:00 p.m.
21	Session Moderators, Plan II Staff
22	Map of Session room locations

Participant and Moderator Check-In

Please pick up a name tag and program at the Plan II table outside
CLA 0.130, 10 a.m.- 3:30 p.m.

Refreshments available next to check-in table, 10:00 a.m. - 4:00 p.m.

Compliments of Plan II Honors Program

The Day at a Glance

SESSION I

10:15 A.M. - 11:45 A.M.

- 1.1 Public Health I:**
Studies in Disparity **CLA 0.130**
Moderator: Ronald Angel
- 1.2 Creative Writing** **CLA 0.128**
Moderator: Matt Valentine
- 1.3 Economics & Efficacy:**
What Works, What Doesn't **CLA 0.126**
Moderator: Katie Pritchett
- 1.4 Perspectives on Education** **CLA 0.112**
Moderator: Norma Cantú
- 1.5 Law & Order:**
The Constitution & The Courts **CLA 0.102**
Moderator: George Christian
- 1.6 Politics, Identity, & Religion**
in the Middle East **CLA 1.106**
Moderator: Samy Ayoub
- 1.7 Biology & Technology** **CLA 1.104**
Moderator: Daniel Johnston

SESSION 2

12:00 P.M. - 1:30 P.M.

- 2.1 Public Health II:**
Equity & Accountability **CLA 0.130**
Moderator: Alfred McAlister
- 2.2 Musical Bridges:**
Local & Global Connections **CLA 0.128**
Moderator: Martin Kevorkian
- 2.3 Marketing Culture/
The Culture of Marketing** **CLA 0.126**
Moderator: Deirdre Mendez
- 2.4 Health & Wellness:**
Healing the Mind & the Body **CLA 0.112**
Moderator: Stephen Sonnenberg
- 2.5 Perspectives on War & Peace** **CLA 0.102**
Moderator: Michael B. Stoff
- 2.6 European Politics:**
Ethics, Economics, Power **CLA 1.106**
Moderator: Megan Seaholm
- 2.7 Performing Identities on
Stage & Screen** **CLA 1.104**
Moderator: David Kornhaber

The Day at a Glance

SESSION 3

1:45 P.M. - 3:15 P.M.

- 3.1 Civic Activism & Engagement** **CLA 0.130**
Moderator: Lee Walker
- 3.2 Feminine Constructions/
Constructing the Feminine** **CLA 0.128**
Moderator: Fatma Tarlaci
- 3.3 African Studies & Black Studies** **CLA 0.126**
Moderator: Paula Newberg
- 3.4 Campus Questions:
Issues in Higher Education** **CLA 0.112**
Moderator: Stephen Sonnenberg
- 3.5 Violence, Rhetoric,
& Human Rights** **CLA 0.102**
Moderator: Michael B. Stoff
- 3.6 The Politics of Progress, Past &
Present, in Latin America** **CLA 1.106**
Moderator: Kurt Weyland
- 3.7 Geological & Biomedical Sciences** **CLA 1.104**
Moderator: David Mohrig

SESSION 4

3:30 P.M. - 5:00 P.M.

- 4.1 Ethical Issues in American
Culture** **CLA 0.130**
Moderator: William Winslade
- 4.2 Creative Drama, Film & Media** **CLA 0.128**
Moderator: Donna Kornhaber
- 4.3 Psychology: Childhood, Adolescence,
& Literature** **CLA 0.126**
Moderator: Fatma Tarlaci
- 4.4 Perspectives of Food & Society** **CLA 0.112**
Moderator: Ruth Buskirk
- 4.5 Urban Ecologies** **CLA 0.102**
Moderator: Simon Atkinson
- 4.6 The Politics of Change &
Intervention in Asia** **CLA 1.106**
Moderator: Sankaran Radhakrishnan
- 4.7 Physics & Engineering** **CLA 1.104**
Moderator: Austin Gleeson

Alphabetical Student Index with Session Number

Anderson, Ashley, 1.7
Arena, Olivia, 3.1
Baker, Austin, 4.7
Banerjee, Shreya, 1.5
Barnett, Jake, 2.5
Bhatnagar, Varun, 2.3
Bleiweiss, Erin, 4.2
Boswell, Thomas, 3.6
Broman, Shelley, 4.5
Brown, Tyler, 2.5
Bueno, Nicole, 2.1
Burdine, Katie, 4.3
Byers, Neil, 2.5
Chan, Tiffany, 1.2
Chu, Nicole, 3.4
Cigarroa, Paloma, 4.4
Craigen, Evelyn, 1.1
Davis, Clayton, 1.6
Devarajan, Sinthuja, 4.6
Dickerson, Austin Reed, 1.5
Divakaruni, Abhay, 1.2
Dorland, Julie, 3.7
Dubey, Neha, 3.2
Dunn, Michelle, 2.4
Engleman, David, 2.7
Epstein, Jori, 3.1
Ewert, Suzanna, 3.2
Eyster, Avery, 1.4
Furst, Caroline, 2.4
Gandhi, Mohnish, 1.3
Gemp, Emily, 4.5
Ghosh, Robina, 2.3
Green, Matthew, 1.4
Gregory, Michael, 4.7
Grube, Daniel, 3.5
Gulde, Andrew, 1.1
Haley, Patrick, 1.7
Hamborsky, Stephanie Danielle, 4.4
Harakal, Timothy, 3.5
Harriman, Paige Leigh, 4.3
Hasegawa, Naomi, 4.1
Healy, Connor, 3.3
Herbst, Kyle, 4.4
Hiebert, Jacob, 2.2
Hoenig, William, 4.7
Hua, Lynn M., 1.1
Hughes, Connor, 1.1
Huynh, Rachel Julie, 3.1
Inhofe, Gabrielle, 1.6
Jackson, Renae, 2.7
Jacobson, Samuel, 2.2
Jencks, Kara, 2.4
Joglekar, Akanksha, 1.3
Joshi, Sneha, 2.1
Joshi, Shalaka, 4.6
Kachelmeyer, Jaclyn Rose, 3.3
Kang, Hannah, 3.2
Knocke, Kathleen Elizabeth, 1.4
Kumar, Savannah, 3.3
Larson, Erin, 2.6
Lau, Stacey, 4.3
Lee, Elizabeth, 4.2
Lim, Stephanie, 2.4
Limbaugh, Lindsey, 2.6
Liu, Samuel, 4.5
Lueder, Leighton Thomas, 2.6
Lyke, Penner, 1.5
Machiorlette, Brette, 3.5
Maliakkal, Janice, 2.1
Malik, Amil, 1.3
Malonis Jr., John, 2.2
Mansberg, Ramie, 1.4
Martin, Maclean, 2.3
McCann, Mac, 2.2
McKeown, Nell, 2.7
McLean, Elizabeth, 3.2
McRoberts, Aliyah, 4.5
Mercer, Josiah Thomas, 2.7
Meyerson, Caroline, 2.3
Mockler, Blair, 1.7
Moore, Elizabeth, 4.2
Morey, Susannah Marie, 3.7
Morris, Heather, 2.6
Nagel, Nicole, 2.4
Nambiar, Madhavi, 3.7
Nicholson, James, 4.2
Noddings, Chari, 4.4
O'Neill, Colleen, 4.3
Oh, Kate, 3.5
Okafor, Somtochi, 1.1
Palermo, Rose, 3.7
Parker, Jonathan, 2.6
Parma, Natalie, 4.6
Patnaik, Anish, 2.1
Patrick, Conner, 3.1
Paulter, Grace, 1.6
Pharr, Luke, 4.7
Pierce, Clemmie, 3.3
Porter, Austin, 1.3
Prabhu, Shruthi, 3.1
Prideaux, Jason, 1.3
Prideaux, Catherine Anne, 2.3
Proffitt, Ann-Charlotte, 1.4
Railey, Stuart, 1.6
Ramamoorthy, Divya, 3.7
Ross, Allen, 1.2
Rudner, Jordan, 1.5
Ryden, Alex, 4.1
Scouller, Jenny, 4.1
Seo, Sang, 4.1
Shing, Loktao, 4.5
Skillicorn, Alexa Torres, 3.6
Smart, Duncan, 2.2
Soto, Paul Alfonso, 1.2
Sridhar, Sid, 4.6
Stark, Meredith, 3.4
Stone, Zachary, 1.5
Swanson, Marisa, 3.4
Tai, Hua-Hsin (David), 1.7
Talukdar, Neal, 4.1
Torres, Gabrielle, 3.6
Trejo, Bianca Hinz Foley, 3.5
Weissgarber, Zach, 1.2
Wellington, Terry-Ann, 3.6
Wilkinson, David, 2.5
Wilson, Andrew, 4.2
Windham, Kendle, 3.2
Woolheater, Tara, 3.4
Zhang, Amy, 3.4
Zhu, Shunan, 4.3

Session One 10:15 - 11:45 a.m.

1.1 Public Health I: Studies in Disparity

CLA 0.130

MODERATOR: RONALD ANGEL, SOCIOLOGY

- Evelyn Craigen The Practice of Inequality: a Review of the Biomedical Sociology Underlying Racial Health Disparities in the US
Supervisor: John Hoberman, Germanic Studies
- Andrew Gulde Antibiotics and Obesity
Supervisor: Ronald Angel, Sociology
- Lynn M. Hua Equity in Access to U.S. Healthcare: Predictors of ACA Application Assistance and Enrollment
Supervisor: Stephen Ryan, Economics
- Connor Hughes Vaccination Campaign on a Large College Campus: Case Study in HPV
Supervisor: Lee Ann Kablor, Advertising
- Somtochi Okafor The Transnational Effects of Racial Discrimination on Black Brazilian and Black American Women's Reproductive Health
Supervisor: Christen Smith, Anthropology/African and African Diaspora Studies

1.2 Creative Writing

CLA 0.128

MODERATOR: MATT VALENTINE, PLAN II HONORS

- Tiffany Chan Inspiration through Narrative: A Story and a Collection
Supervisor: Marjorie C. Woods, English
- Abhay Divakaruni Brethren
Supervisor: Kurt Heinzelman, English
- Allen Ross Mrs. Massive: A Narrative About Art, Grief, and Superheroes
Supervisor: Matt Valentine, Plan II Honors
- Paul Alfonso Soto Our Fort & Other Stories
Supervisor: Edward Carey, English
- Zach Weissgarber Deshecho
Supervisor: Delia Montesinos, Spanish

1.3 Economics & Efficacy: What Works, What Doesn't

CLA 0.126

MODERATOR: KATIE PRITCHETT, MANAGEMENT

- Mohnish Gandhi *Any Interest in Payday Loan Regulation: An Analysis of Payday Loans and their Effects on Society*
Supervisor: Katie Pritchett, Management
- Akanksha Joglekar *Serving up the Strategies: An Analysis of Employee Turnover in the Fast Casual Food Industry*
Supervisor: Kelly Kamm, Finance
- Amil Malik *Pakistan Stock Exchange (PSX): An Analysis on Efficiency and Returns*
Supervisor: Beverly Hadaway, Finance
- Jason Prideaux *The Financial Crisis of 2008: An Examination of the Great Recession*
Supervisor: Greg Hallman, Finance
- Austin Porter *Behavioral Incentives and Moral Hazard in Health Insurance Markets*
Supervisor: Michael Geruso, Economics

1.4 Perspectives on Education

CLA 0.112

MODERATOR: NORMA CANTU, EDUCATION/LAW

- Avery Eyster *Affirmative Action Policies and Their Impact on the Persistence of STEM Majors at UT Austin: A Qualitative and Quantitative Approach*
Supervisor: Norma Cantú, Education/Law
- Matthew Green *Charter Schools: The Intersection of Innovative Curriculum and Extracurricular Activities*
Supervisor: Coleman Hutchison, English
- Kathleen Elizabeth Knocke *Evaluation of the Effectiveness of Pre-Participation UIL Physicals in Identifying Key Health Risk Factors in High School and Middle School Athletes*
Supervisor: Jane Champion, School of Nursing
- Ramie Mansberg *The Game Beyond the Field: High School Football as a Mechanism for Combatting Childhood Adversity*
Supervisor: Daron K. Roberts, Center for Sports Leadership and Innovation
- Ann-Charlotte Proffitt *How Teachers' Perspectives Influence Discipline and Reward at KIPP Austin Academy of Arts and Letters*
Supervisor: Robert Crosnoe, Sociology

1.5 Law & Order: The Constitution & the Courts

CLA 0.102

MODERATOR: GEORGE CHRISTIAN, ENGLISH

- Shreya Banerjee Reliving the Nightmare: Developing a Better System of Rehabilitation for
Minor Victims of Human Trafficking
Supervisor: Allison Benesch, School of Law
- Austin Reed Dickerson The Rural Healthcare Access Dilemma: A Case Study of Duval County, Texas
Supervisor: William Sage, School of Law
- Penner Lyke Myriad Genetics: A Case for Greater Accountability in the United States Court of
Appeals for the Federal Circuit
Supervisor: John Golden, School of Law
- Jordan Rudner Reporting the Court: Supreme Court Coverage in the 20th and 21st Centuries
Supervisor: Gina Chen, Journalism
- Zachary Stone Constitutional Approaches to Texas Education Finance
Supervisor: George Christian, English

1.6 Politics, Identity & Religion in the Middle East

CLA 1.106

MODERATOR: SAMY AYOUB, MIDDLE EASTERN STUDIES

- Clayton Davis Revisiting the Six Day War: A Hydrological Perspective on Zionism
Supervisor: Michael Anderson, International Relations and Global Studies
- Gabrielle Inhofe Israeli Cinema: Orientalism, the Construction of Identity, and Challenges to the
National Narrative
Supervisor: Michael Anderson, International Relations and Global Studies
- Grace Paulter Arabic and Gender: Analyzing the Relationship between Language and
Gender in Society
Supervisor: Kristen Brustad, Middle Eastern Studies
- Stuart Railey Mujahidat: Women of the Islamic State
Supervisor: Michael Anderson, International Relations & Global Studies

1.7 Biology & Technology

CLA 1.104

MODERATOR: DANIEL JOHNSTON, NEUROSCIENCE

- Ashley Anderson The Effects of Various Alcohols on Developing Zebrafish
Supervisor: Johann Eberhart, Molecular Biology
- Patrick Haley The Evolution of Language Groups among Cooperating Digital Predators
Supervisor: Risto Miikkulainen, Computer Science
- Blair Mockler Plight of the Bumblebee: The Bumblebee Microbiome and its Impact on Pathogen
Infection Rates
Supervisor: Nancy Moran, Integrative Biology
- Hua-Hsin (David) Tai H Channels Readouts and the Effects of Synaptic Background Activity through
Modeling of Layer 5b Pyramidal Cells
Supervisor: Daniel Johnston, Neuroscience

Session Two 12:00 - 1:30 p.m.

2.1 Public Health II: Equity & Accountability CLA 0.130

MODERATOR: ALFRED MCALISTER, UT SCHOOL OF PUBLIC HEALTH

- Nicole Bueno Evaluating the Utility of the ‘New Molecular Entity’ Pharmaceutical Distinction
Supervisor: Brian Richter, Business, Government & Society
- Sneha Joshi Income Inequality and Population Health: Developing Equity through
Health Education
Supervisor: Alfred McAlister, UT School of Public Health
- Janice Maliakkal Determinants, Consequences, and Effective Solutions for Health Implications of
U.S. “Food Deserts”
Supervisor: Alfred McAlister, UT School of Public Health
- Anish Patnaik How do Accountable Care Organizations Change the Interaction Between Patients
and Physicians
Supervisor: Alfred McAlister, UT School of Public Health

2.2 Musical Bridges: Local & Global Connections CLA 0.128

MODERATOR: MARTIN KEVORKIAN, ENGLISH

- Jacob Hiebert A Desire To Connect: A Snapshot of the Current State of the Chinese Independent
Music Industry
Supervisor: Lee Walker, Plan II Honors
- Samuel Jacobson A Musical Middle Class? Patronage In Austin, Texas, Amid The Shattered Global
Music Economy
Supervisor: Martin Kevorkian, English
- John Malonis Jr. Shoulder the Ghost: An Autoethnographic Study of Songwriting and the Grieving
Process
Supervisor: George Christian, English
- Mac McCann MCs & Marx: Examining Rap from a Historical Materialistic Approach
Supervisor: Chad Seales, Religious Studies
- Duncan Smart The Rolling Stones and Cultural Bridges: The Migration of the Blues to Britain
and Back Again
Supervisor: Charles Carson, Musicology

2.3 Marketing Culture/The Culture of Marketing

CLA 0.126

MODERATOR: DEIRDRE MENDEZ, MARKETING

- Varun Bhatnagar Money, Fame, and Asian Pop: The Impact of Celebrities on East Asian Cultures of Consumption
Supervisor: Deirdre Mendez, Marketing
- Robina Ghosh Consumer Behavior of the Middle Class in West Bengal
Supervisor: Frenkel Ter Hofstede, Marketing
- Maclean Martin Three Tiers for Texas Beers: An Analysis of Texas Distribution Legislation's Impact on the Craft Beer Industry,
Supervisor: William Cunningham, Marketing
- Caroline Meyerson Brand Crisis and Management
Supervisor: John Highbarger, Marketing
- Catherine Anne Prideaux Is Texas the New Napa? Assessing the Viability of the Texas Hill Country as an Emerging Wine Region
Supervisor: Joe Hahn, Finance

2.4 Health & Wellness: Healing the Mind & the Body

CLA 0.112

MODERATOR: STEPHEN SONNENBERG, SCHOOL OF ARCHITECTURE

- Michelle Dunn Rhythm and Blues: The Effect of Music on Movement Patterns and Anxiety
Supervisor: Larry Abraham, Kinesiology and Health Education
- Caroline Furst Corporate Health and Wellness Programs: How Workplace Health Programs Influence Company Appeal to the Millennial Generation
Supervisor: John Bartholomew, Kinesiology and Health Science
- Kara Jencks When the Evidence Contradicts the Clinical Impression: How Doctors Think and What They Do
Supervisor: Stephen Sonnenberg, School of Architecture
- Stephanie Lim The Therapeutic Effects of Yogic Practices
Supervisor: Stephen Phillips, Philosophy
- Nicole Nagel The Nature of Naturopathic Medicine: How the Doctor-Patient Relationship is an Integral Component
Supervisor: Jan Todd, Kinesiology and Health Education

2.5 Perspectives on War & Peace

CLA 0.102

MODERATOR: MICHAEL B. STOFF, HISTORY/PLAN II HONORS

- Jake Barnett When Culture Eats Strategy: Examining the Phoenix/Phung Hoang Bureaucracy in the Vietnam War
Supervisor: Jeremi Suri, History
- Tyler Brown Hacking or Active Defense: What does an International Agreement on Cyber Security Look Like?
Supervisor: Michael Anderson, International Relations & Global Studies
- Neil Byers The 'Big E' and The 'Mighty T': Ship Memorials in American War Memory, 1945-1958
Supervisor: Michael B. Stoff, History/Plan II Honors
- David Wilkinson Contemporary Dynamics of Military Change: The Royal Marines from the Falklands to Afghanistan
Supervisor: Lance Bertelsen, English

2.6 European Politics: Ethics, Economics, Power

CLA 1.106

MODERATOR: MEGAN SEAHOLM, HISTORY

- Erin Larson The European Central Bank: Independent Bank or Supranational Hegemon
Supervisor: James K. Galbraith, LBJ School
- Lindsey Limbaugh A Bitter Pill for the Catholic Church: Analyzing Italian Journalists' Response to *Humanae Vitae*
Supervisor: Megan Seaholm, History
- Leighton Thomas
Lueder Albert Einstein and Philosophy: How Einstein used Philosophy to Develop His Relativity Theory and How Ethicists Have Used Einstein's Relativity Since Its Development
Supervisor: Alberto Martinez, History
- Heather Morris From Steam Power to Artificial Intelligence: Advancements in Automation and the Prospect of a Post-Work Economy in the First and Second Machine Ages
Supervisor: Tracie Matysik, History
- Jonathan Parker Inventing Czechoslovakia: How Elites Abroad Legitimated a Czechoslovak State
Supervisor: Tatjana Lichtenstein, History

2.7 Performing Identities on Stage & Screen

CLA 1.104

MODERATOR: DAVID KORNHABER, ENGLISH

- David Engleman Constructions of American Masculinity at the Turn of the Century: American Beauty, Fight Club, and Office Space
Supervisor: Donna Kornhaber, English
- Renaë Jackson Insanity in the Works of Shakespeare and his Contemporaries and its Presentation in Modern Theater
Supervisor: James Loehlin, English
- Nell McKeown "And I Am Ready To Put Armor On": The Women of Shakespeare's Histories in Performance
Supervisor: James Loehlin, English
- Josiah Thomas Mercer Shakespeare's Monarchy: Learning from the Political Plays
Supervisor: James Loehlin, English

Session Three 1:45 - 3:15 p.m.

3.1 Civic Activism & Engagement

CLA 0.130

MODERATOR: LEE WALKER, PLAN II HONORS

- Olivia Arena Urban Guerilla Movements: Urban Interventions as Civic Engagement
Supervisor: Paul Adams, Urban Studies
- Jori Epstein Uncovering the Street Newspaper Movement: Faces & Strategies of a Hidden
Journalism
Supervisor: Wanda Cash, Journalism
- Rachel Julie Huynh Empower Impoverished, Rural Women: An Exploratory Study of Social
Enterprise
Supervisor: Lee Walker, Plan II Honors
- Conner Patrick Impact Investing: Growing the Global Market for a Burgeoning Industry
Supervisor: David Warner, LBJ School
- Shruthi Prabhu Advocating for an Agenda: Micro-functions and Gaining Traction in Government
Supervisor: John Daly, Communication Studies

3.2 Feminine Constructions/Constructing the Feminine

CLA 0.128

MODERATOR: FATMA TARLACI, PLAN II HONORS

- Neha Dubey Plot in the Time of Einstein: Examining Narratives of Entropy and Relativity in
Woolf's Interbellum Works
Supervisor: George Christian, English
- Suzanna Ewert The Man in the Red-Caped Suit: Superman, Lois Lane, and Postwar Domesticity
Supervisor: Penne Restad, History
- Hannah Kang The Transformation of Sacrifice and Society in The Hunger Games
Supervisor: Tracie Matysik, History
- Elizabeth McLean Feminine Corporeality and Conflict in European Fairy Tales
Supervisor: Sandra B Straubhaar, Germanic Studies
- Kendle Windham Grotesque Beauty: David Foster Wallace's and Alexander McQueen's Postmodern
Construction of the Feminine
Supervisor: Elizabeth Richmond-Garza, English

3.3 African Studies & Black Studies

CLA 0.126

MODERATOR: PAULA NEWBERG, GOVERNMENT

- Connor Healy "Kill the Boer": Anti-Blackness and the (Im)possibility of White Revolutionary Praxis
Supervisor: João H. Costa Vargas, African and African Diaspora Studies
- Jaclyn Rose Accinelli Kachelmeyer Beyond Terroir: The Political Ecology of Climate Change, Production, and Transformation in the South African Wine Industry
Supervisor: Michael Anderson, International Relations and Global Studies
- Savannah Kumar Community and Emergency: Responses to the 2014 Ebola Outbreak in Liberia
Supervisor: Paula Newberg, Government
- Clemmie Pierce Evaluating Educational Disparities in Developing Nations: A Case Study of Primary Education in Uganda
Supervisor: Mike Findley, Government

3.4 Campus Questions: Issues in Higher Education

CLA 0.112

MODERATOR: STEPHEN SONNENBERG, PLAN II HONORS/ARCHITECTURE

- Nicole Chu Mezzo Justice: The Management of Sexual Assault on Campus
Supervisor: Diane McDaniel Rhodes, Social Work
- Meredith Stark The Effects of Dormitory Architecture on Resident Behavior and Community Development at the University of Texas at Austin
Supervisor: Stephen Sonnenberg, Plan II Honors/ Architecture
- Marisa Swanson We Will Not Go Quietly: The Millennial Transformation of College Mental Health Culture
Supervisor: Diane McDaniel Rhodes, Social Work
- Tara Woolheater "It Will Look Good On Your Résumé": Reconsidering Internship Experiences as Critical For Employment
Supervisor: Brenda Berkelaar, Communication Studies
- Amy Zhang Sexual Violence and College Masculinities within the U.S. Higher Education System, with an Emphasis on Large Campuses such as the University of Texas at Austin
Supervisor: Gloria González-López, Sociology

3.5 Violence, Rhetoric, & Human Rights

CLA 0.102

MODERATOR: MICHAEL B. STOFF, HISTORY/PLAN II HONORS

- Daniel Grube Terrorist Financing
Supervisor: Jeremi Suri, LBJ School
- Timothy Harakal A Reverend's Rhetoric: Recruiting for Missions to the Muslim World
Supervisor: Davida Charney, Rhetoric and Writing
- Brette Machiorlette Responses to 9/11: How Fear Impacted Policy Change Along the U.S.-Mexico Border
Supervisor: Steven Hoelscher, American Studies
- Kate Oh Populism, Terrorism, and the Decline of Human Rights
Supervisor: Terrence Chapman, Government
- Bianca Hinz Foley Trejo listening in a time of war: on violence, peacemaking, and the rhetoric of listening
Supervisor: Rasha Diab, Rhetoric and Writing

3.6 The Politics of Progress, Past & Present, in Latin America CLA 1.106

MODERATOR: KURT WEYLAND, LATIN AMERICAN STUDIES

- Thomas Boswell The Grand Canal: Applying Political Science Theory to Explain Puzzling Policy Decisions in Contemporary Nicaragua
Supervisor: Kurt Weyland, Latin American Studies
- Alexa Torres Skillicorn Reclaiming Cueca: The Brava Tradition and Imagined Identities among Santiago's Cuequeros
Supervisor: Seth Garfield, History
- Gabrielle Torres The Use of Archives in Guatemala's Postwar Human Rights Prosecution
Supervisor: Daniel Brinks, Government
- Terry-Ann Wellington Exploring the Shifts Between the Alliance for Progress and the Mann Doctrine
Supervisor: Mark Lawrence, History

3.7 Geological & Biomedical Sciences

CLA 1.104

MODERATOR: DAVID MOHRIG, GEOLOGICAL SCIENCES

- Julie Dorland Variable Response to Chemotherapeutics by a Subpopulation of MCF-7 Breast Cancer Cells
Supervisor: Amy Brock, Biomedical Engineering
- Susannah Marie Morey The Evolution of the Surveyor Fan and Channel in the Gulf of Alaska, Based on Core-Log-Seismic Integration at IODP Site U1417
Supervisor: Sean Gulick, Geological Sciences, Institute for Geophysics
- Madhavi Nambiar The Effects of Oxidative Stress via High Glucose on Mouse Embryoid Body Formation
Supervisor: Janet Zoldan, Biomedical Engineering
- Rose Palermo Variability in Rates and Styles of Shoreline Retreat Generating a Sea Cliff and Wave-Cut Platform at Sargent Beach, Texas
Supervisor: David Mohrig, Geological Sciences
- Divya Ramamoorthy The Effect of Mechanotransduction on Cell Growth and Differentiation
Supervisor: Laura Suggs, Biomedical Engineering

Session Four 3:30 - 5:00 p.m.

4.1 Ethical Issues in American Culture

CLA 0.130

MODERATOR: WILLIAM WINSLADE, PHILOSOPHY

- Naomi Hasegawa Transcending the Fate of a Convicted Pedophile: A Case Study on Mr. T's
Castration and Change
Supervisor: William Winslade, Philosophy
- Alex Ryden Palliative Sedation: The Solution to the Ethical Quandary of Euthanasia
Supervisor: William Winslade, Philosophy
- Jenny Scouller Pit Bull Phobia: The Influence of Media, Socioeconomics and Legislation
Supervisor: Janet Davis, American Studies
- Sang Seo Mutation in the Name of Love: A Perspective on Pure-Breeding and
English Bulldogs
Supervisor: Janet Davis, American Studies
- Neal Talukdar Evolution of Shock Trauma: An Analysis of Critical Care Medicine in Combat
from the Vietnam War to the War on Terror
Supervisor: William Winslade, Philosophy

4.2 Creative Drama, Film & Media

CLA 0.128

MODERATOR: DONNA KORNHABER, ENGLISH

- Erin Bleiweiss Moot: An Exploration of Digital Design and Culture Through Mobile Application
Development
Supervisor: Robert Quigley, Journalism
- Elizabeth Lee The Seedling's Song: An Original Screenplay
Supervisor: Donna Kornhaber, English
- Elizabeth Moore The Story of Myrrha: Tragedy Redefined
Supervisor: Liz Engelman, Theatre & Dance
- James Nicholson Resilience: Decision-Making and Despair in Total War
Supervisor: Sheldon Pacotti, Radio-Television-Film
- Andrew Wilson Journey to the Center of the Rectum: A Sex Education Puppet Show for Men
who have Sex with Men
Supervisor: PJ Raval, Radio-Television-Film

4.3 Psychology: Childhood, Adolescence, & Literature

CLA 0.126

MODERATOR: FATMA TARLACI, PLAN II HONORS

- Katie Burdine Captivated by a Vampire: A Psychosocial Approach to Exploring the Fascination with Fictional Characters among Female Adolescents
Supervisor: Hannab Wojciehowski, English
- Paige Leigh Harriman A Good Book: The Healing Power of Stories for Children with Trauma or Depression
Supervisor: Jerome Bump, English
- Stacey Lau Occupational Therapy for Children with Sensory Processing Issues: What We Know and What Parents Think
Supervisor: Lauretta Reeves, Psychology
- Colleen O'Neill We're All Mad Here: An Exploration of Madness in Alice in Wonderland
Supervisor: Jerome Bump, English
- Shunan Zhu Stress and the Developing Brain: Ameliorating the Consequences of Childhood and Adolescent Adversity
Supervisor: Yvon Delville, Psychology

4.4 Perspectives of Food & Society

CLA 0.112

MODERATOR: RUTH BUSKIRK, MOLECULAR GENETICS & MICROBIOLOGY

- Paloma Cigarroa A Comparison of Parent vs. Child Reports on Eating Behavior and Implications on Dietary Intake in Overweight Hispanic 7-10 year-olds
Supervisor: Jaimie Davis, Nutritional Sciences
- Stephanie Danielle
Hamborsky Achieving Community Food Security and Racial Justice: A Case Study of East Austin
Supervisor: Robert Jensen, Journalism
- Kyle Herbst Sugar High: A Modern Content Analysis of Children's Food Advertisements in a Changing Landscape of Nutrition Standards and Industry Regulations since 2003
Supervisor: Lee Ann Kablor, Advertising
- Chari Noddings Barriers to Humanitarian Uses of Genetically Modified Organisms: Lessons from the Golden Rice Project
Supervisor: Ruth Buskirk, Molecular Genetics and Microbiology

4.5 Urban Ecologies

CLA 0.102

MODERATOR: SIMON ATKINSON, ARCHITECTURE

- Shelley Broman *Dam It!: Austin's Water Supply, Use, and Technology Past, Present, and Future*
Supervisor: Lydia Contreras, Chemical Engineering
- Emily Gemp *The Intersection of Office Life and Social Life: A New Urban Design in Manhattan and Central London*
Supervisor: Simon Atkinson, Architecture
- Samuel Liu *The Case for Small-Scale Wind Turbines: Urban Applications for Commercial and Residential Use*
Supervisor: Lucy Atkinson, Communications
- Aliyah McRoberts *A Highway Runs Through It: A Historical Analysis of Austin's Problematic IH-35, and Recommendations for the Future*
Supervisor: Randolph Lewis, American Studies
- Loktao Shing *An Examination for the Feasibility of Micro Wind Turbines in Urban Environments*
Supervisor: Atila Novoselac, Civil Engineering

4.6 Politics of Change & Intervention in Asia

CLA 1.106

MODERATOR: SANKARAN RADHAKRISHNAN, SOUTH ASIAN STUDIES

- Sinthuja Devarajan *Exploring Bharatanatyam and Choreography through the Sutured History of Devadasis*
Supervisor: Sankaran Radhakrishnan, South Asian Studies
- Shalaka Joshi *Chinese Expansionism in Asia: The American and Indian Foreign Policy Perspectives*
Supervisor: Mark Lawrence, History
- Natalie Parma *Rebuilding a Kingdom: The Development of NGOs in Cambodia, 1975-Present*
Supervisor: Ronald Angel, Sociology
- Sid Sridhar *Socioeconomic Change and Caste Mobility: A Study of Toddy-tapping Castes in the Madras Presidency from 1870 to 1930*
Supervisor: Sumit Guba, History

4.7 Physics & Engineering

CLA 1.104

MODERATOR: AUSTIN GLEESON, PHYSICS

- | | |
|-----------------|--|
| Austin Baker | Sound Propagation in Additively Manufactured Air Cavity Resonators
<i>Supervisor: Carolyn Seepersad, Mechanical Engineering</i> |
| Michael Gregory | Optimizing Replicated State Machines for Multi-Core Computation and Nested Services in the Adam Framework
<i>Supervisor: Lorenzo Alvisi, Computer Science</i> |
| William Hoenig | MicroWorld: A Framework for Simulation of the Macroeconomy from Microeconomic Actors
<i>Supervisor: Craig M. Chase, Electrical and Computer Engineering</i> |
| Luke Pharr | Buckling of a Plastic Sheet
<i>Supervisor: Michael Marder, Physics</i> |

Session Moderators

We are very grateful to those who served as session moderators at this symposium

Ronald Angel	David Kornhaber	Megan Seaholm
Simon Atkinson	Donna Kornhaber	Stephen Sonnenberg
Samy Ayoub	Alfred McAlister	Michael B. Stoff
Ruth Buskirk	Deirdre Mendez	Fatma Tarlaci
Norma Cantú	David Mohrig	Matt Valentine
George Christian	Paula Newberg	Lee Walker
Austin Gleeson	Katie Pritchett	Kurt Weyland
Daniel Johnston	Sankaran	William Winslade
Martin Kevorkian	Radhakrishnan	

Plan II Staff

Michael B. Stoff, Director

Alexandra K. Wettlaufer, Associate Director

Richard Reddick, Assistant Director

Mary Dillman, Academic Advisor

Phillip Dubov, Alumni Liaison

Melissa Ossian, Academic Advisor

Kerry Pasquale, Admissions Director

Elsie Reboloso, Office Manager

Fatma Tarlaci, Teaching Assistant

Matt Valentine, Joynes Room Coordinator



CLA BASEMENT ROOM LOCATIONS

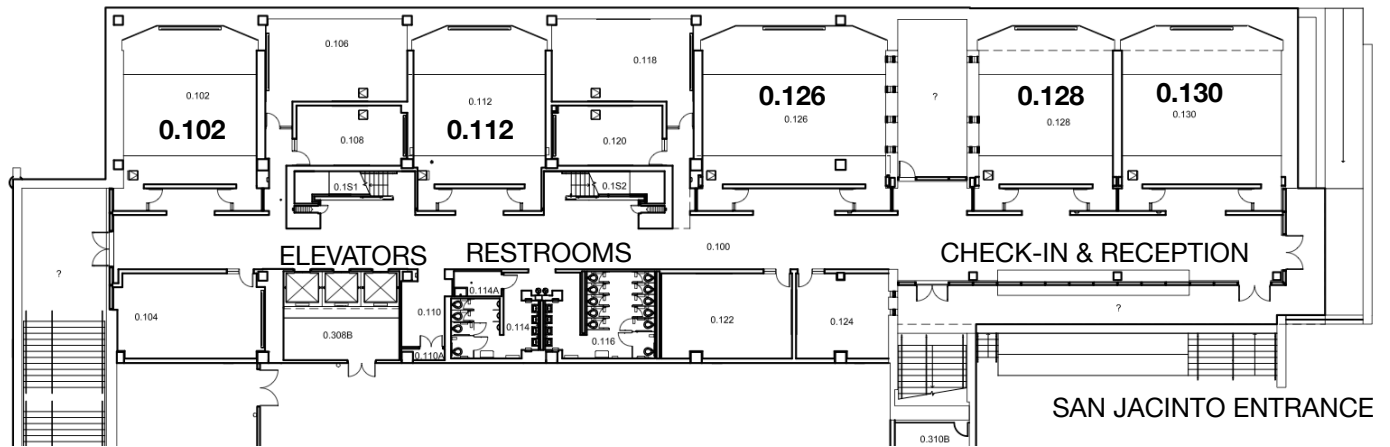

CLA FIRST FLOOR ROOM LOCATIONS

