

PLAN II FALL THESIS

Symposium



NOVEMBER 15, 2015



CONTENTS

2	The Day at a Glance
3	Alphabetical Index of Students with Session Number
4	Session One 1:00 p.m. - 2:30 p.m.
6	Session Two 2:45 p.m - 4:15 p.m.
8	Session Moderators, Plan II Staff
9	Map of Session room locations

Participant and Moderator Check-In

Please pick up a name tag and program at the Plan II table
outside CLA 0.130, 12:30 p.m. - 3:30 p.m.

Refreshments available next to the check-in table, 12:30 p.m. to 3:30 p.m.

Compliments of Plan II Honors Program

The Day at a Glance

SESSION I

1:00 - 2:30 PM

1.1 Business, Government & Society **CLA 0.130**
Moderator: Rhonda Evans

1.2 Issues in Modern America **CLA 0.128**
Moderator: Fatma Tarlaci

1.3 Creative: Words/Film/Fashion **CLA 0.126**
Moderator: Matt Valentine

SESSION 2

2:45 - 4:15 PM

2.1 Education & Sports **CLA 0.130**
Moderator: John Hoberman

2.2 The Humanities & Our World **CLA 0.128**
Moderator: Brian Doherty

2.3 Identity: Language & Psychology **CLA 0.126**
Moderator: Fatma Tarlaci

2.4 Health & Biological Sciences **CLA 0.112**
Moderator: Richard Reddick

Alphabetical Student Index with Session Number

Batson, R. Austin; 2.1
Bayley, Graham; 2.3
Berthelsen, Philip; 1.1
Bhattacharjee, Gitanjali; 1.2
Cavanaugh, Brian P.; 1.2
Chacko, Priya; 2.4
Danaher, Conor; 1.1
Fan, Luther; 2.1
Haight, Amanda; 2.3
Heymann, Lauren; 2.4
Hinz-Trejo, Bianca; 2.2
Idonor, Ehigbor; 2.3
Jea, Irene; 2.3
Joselevitz, Ronit; 1.3
Kang, Ayesha; 2.1
Koepke, Courtney; 2.4
Leone, Lillie; 1.1
Lockwood, Haley; 2.4
Mahajan, Apoorva; 2.2
Malonis Jr., John Adam; 2.2
McClure, Charlotte; 1.2
Mery, Hannah; 2.2
Moore, Thomas; 1.1
Noe, Lillie; 1.3
Schochet, Melanie; 1.3
Scully, Melinda; 1.3
Seo, Sage; 1.2
Simmons, Nathan; 1.3
Singhal, Aaryaman; 1.1
Stewart, Ashley; 2.4
Trejo, Sam; 2.1

Session One 1:00 - 2:30 p.m.

1.1 Business, Government & Society

CLA 0.130

MODERATOR: RHONDA EVANS, GOVERNMENT

- Philip Berthelsen Information Breach Crises: Analyzing the Causes of Information Breach Incidents in Federal Agencies
Supervisor: Huseyin Tanriverdi, Information, Risk, Operations Management
- Conor Danaher Privilege & Procedure: Analyzing Business Group Lobbying in the Australian Senate
Supervisor: Rhonda Evans, Government
- Lillie Leone The Contemporary Purposes of the Past: Evaluating the Use of Cultural Heritage as a New Paradigm for Socio-Economic Development
Supervisor: Catherine Weaver, LBJ School of Public Affairs
- Thomas Moore The Greatest Good: How Impact Metrics Help Donors Give More Efficiently
Supervisor: Keith Brown, Finance
- Aaryaman Singhal Supporting Those Driven by Prosocial Motivations: A Study of Social Entrepreneurs
Supervisor: Ethan Burris, Management

1.2 Issues in Modern America

CLA 0.128

MODERATOR: FATMA TARLACI, PLAN II HONORS

- Gitanjali Bhattacharjee Too Hot to Handle? Austin's Surface Urban Heat Island
Supervisor: Lance Manuel, Civil, Architectural, and Environmental Engineering
- Brian P. Cavanaugh Determinants of Great Cities: What Drives Cities' Success and an Outlook for Dallas
Supervisor: Jay Hartzell, Finance
- Charlotte McClure A Rebellious Persistence: Lifestyles and Motivations of Small-Scale Farmers in Texas
Supervisor: Gregory Knapp, Geography
- Sage Seo Mutation in the Name of Love: A Perspective on Pure-Breeding and English Bulldogs
Supervisor: Janet M. Davis, American Studies

1.3 Creative: Words/Film/Fashion

CLA 0.126

MODERATOR: MATT VALENTINE, PLAN II HONORS

- Ronit Joselevitz *Mexican Cultural Identity Through Talavera Poblana: A 2017 Resort Collection
by Ronit Joselevitz
Supervisor: Susan Deans-Smith, History*
- Lillie Noe *Organic Machine: Vintage Fashion Meets Modern Techniques
Supervisor: Ann Reed, Textiles and Apparel*
- Melanie Schochet *B Plus: A Situation Comedy
Supervisor: Tom Willett, Radio-Television-Film*
- Nathan Simmons *Gweilo
Supervisor: Tom Willett, Radio-Television-Film*
- Melinda Scully *The Last Earth Mother: A Novella
Supervisor: Oscar Casares, English*

Session Two 2:45 - 4:15 p.m.

2.1 Education & Sports

CLA 0.130

MODERATOR: JOHN HOBERMAN, GERMANIC STUDIES

- R. Austin Batson Improving Technology Integration in the Classroom
Supervisor: Walter Stroup, Curriculum & Instruction
- Luther Fan The Problem with Hoop Dreams: How Socio-economic Backgrounds Affect the Odds of Playing in the NBA
Supervisor: John Hoberman, Germanic Studies
- Ayesha Kang Measuring the Effects of Grade Retention on Students: Implications for Texas Policy
Supervisor: Jennifer Holme, Educational Administration
- Sam Trejo What's Your Major? An Econometric Analysis of the College Major Choice of Disadvantaged Students
Supervisor: Gerald Oettinger, Economics

2.2 The Humanities & Our World

CLA 0.128

MODERATOR: BRIAN DOHERTY, ENGLISH

- Bianca Hinz-Trejo At War with Peace: On Violence and Peacemaking Rhetoric
Supervisor: Rasha Diab, Rhetoric and Writing
- Apoorva Mahajan Bodies of Knowledge: The Humanities as a Vehicle and Vessel for Social Mobility
Supervisor: Paul Woodruff, Philosophy
- John Adam Malonis Jr. Carry the Ghost: Songwriting and the Grieving Process
Supervisor: George Christian, English
- Hannah Mery Music as a Form of Protest in the Middle East: Challenging Social and Political Norms in Lebanon
Supervisor: Brian Doherty, English

2.3 Identity: Language & Psychology

CLA 0.126

MODERATOR: FATMA TARLACI, PLAN II HONORS

- Graham Bayley Regional Nationalism: Texas and Catalonia
Supervisor: Jeremi Suri, LBJ School of Public Affairs
- Amanda Haight Beyond Case Marking in the Interpretation of German Prepositional Phrases
Supervisor: John Beavers, Linguistics
- Ehigbor Idonor Je te compterais mes histoires: A Play of Postulations about the Language
Bioprogram Hypothesis
Supervisor: Catherine Echols, Psychology
- Irene Jea Conceptualizing Death: How Individual Differences Impact Belief in the Afterlife
Supervisor: Cristine Legare, Psychology

2.4 Health & Biological Sciences

CLA 0.112

MODERATOR: RICHARD REDDICK, PLAN II HONORS

- Priya Chacko The Human Thermoregulation Simulator
Supervisor: Kenneth Diller, Biomedical Engineering
- Lauren Heymann A Comparative Biogeochemical and Trophic Analysis of Marsh and Mangrove
Habitats in the Gulf Of Mexico
Supervisor: Ken Dunton, Marine Science
- Courtney Koepke Recognitive Polymer Shells on Surface-Modified Gold Nanomaterials for
Biosensing Applications
Supervisor: Nicholas Peppas, Biomedical Engineering
- Haley Lockwood Smart Toilet Technology: Application, Valuation and Feasibility of a Disruptive
Innovation Framework for Advancing Personalized Medicine
Supervisor: Lee Walker, Plan II Honors
- Ashley Stewart Genome-Wide Association and Depression: The Search for Sad Genes
Supervisor: Janine Fischer, Molecular Biosciences

Session Moderators

We are very grateful to those who served as session moderators at this symposium

Brian Doherty
Rhonda Evans
John Hoberman
Richard Reddick
Fatma Tarlaci
Matt Valentine

Plan II Staff

Michael B. Stoff, Director
Alexandra K. Wettlaufer, Associate Director
Richard J. Reddick, Assistant Director

Mary Dillman, Academic Advisor
Phillip Dubov, Alumni Liaison
Melissa Ossian, Academic Advisor
Kerry Pasquale, Admissions Director
Elsie Reboloso, Office Manager
Fatma Tarlaci, Teaching Assistant
Matt Valentine, Joynes Room Coordinator



CLA BASEMENT ROOM LOCATIONS

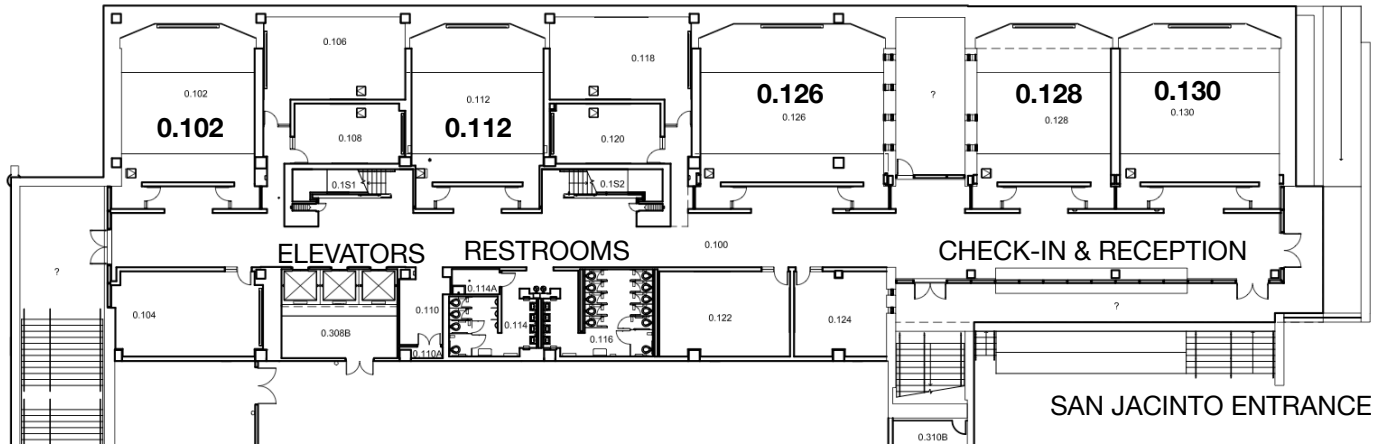

CLA FIRST FLOOR ROOM LOCATIONS

